



**REVISED**  
**CATALOGUE**

of the

**Thirty Sixth Annual Hardwood Timber Auction**

**Thursday 30<sup>th</sup> November 2023**  
**at 2.00p.m.**

**At:**  
**The Corinium Stadium**  
**Cirencester**  
**Gloucestershire**

**Lot 3**



**REVISED CATALOGUE**

**of the Thirty Sixth**

**ANNUAL HARDWOOD TIMBER AUCTION**

**ON BEHALF OF**

**FORESTRY ENGLAND**

**AND**

**PRIVATE TIMBER GROWERS**

**OF HARDWOOD, STANDING AND LOGS  
AND CONIFER LOGS**

**from the following areas:**

**Buckinghamshire, Gloucestershire, Hampshire,  
Isle of Wight, Norfolk, Somerset and West Sussex**

**To be held at**

**Corinium Stadium  
Cirencester  
Gloucestershire  
GL7 1FS**

**ON THURSDAY 30<sup>th</sup> NOVEMBER 2023**

**At 2.00pm**

**\*\*\*\*\***

**David James  
87 Monnow Street, Monmouth NP25 3EW  
Telephone 01600 712916**

**Email: [monmouth@david-james.co.uk](mailto:monmouth@david-james.co.uk)  
Website: [david-james.co.uk](http://david-james.co.uk)**

**\*\*\*\*\***

## **FOREWORD**

This will be the 36<sup>th</sup> Annual Hardwood Auction, again being held at the Corinium Stadium in Cirencester. Last year saw the first Auction following Covid which inevitably was smaller, in terms of volume on offer, than the pre-Covid sales.

This year there is a step forward with nearly 17,000 cubic metres on offer, as against 4,700 last year, a substantial amount of which is in the Standing Sale section. There is also a reasonable entry in Logs at Roadside, mainly from the New and Dean Forests.

There are nine Lots of pure Softwood including Lot 8 – Douglas from Quantock with a mean tree size of 8.2 m<sup>3</sup>.

We very much look forward to seeing everyone on sale day. It is always nice to have a well attended sale room which has always been the tradition over the past 35 years. However, if you are unable to attend please do not forget that we do offer a service of bidding on your behalf. If that is the case for you this year please contact us if you are uncertain of the procedure. Although we would much prefer to see you in attendance.

Have a successful sale.

\*\*\*\*\*

Light Refreshments will be Available

At the Corinium Stadium

\*\*\*\*\*

## **GENERAL CONDITIONS OF SALE - HARDWOOD TIMBER SALE 2023**

*Please note that as from 1 April 2019 Forestry England is the forestry business agency of the Forestry Commission acting in exercise of the powers and duties contained in the Forestry Act 1967.*

1. The sale of each Lot offered at this auction is subject to the printed conditions contained in this catalogue and each Lot sold will be subject to either a Forestry England Standard Contract or a Memorandum of Agreement and Standard Conditions of Sale, dependant on the Vendor of each Lot, specimens of which may be obtained from the Vendors and/or the Auctioneers and which will be available for scrutiny in the auction rooms. The contact name and address of the Vendor is given with the details of each Lot.
2. The Vendor reserves the right to make one bid for each Lot (the reserve price), which shall be delivered to the Auctioneer in a sealed envelope before the commencement of the sale.
3. The highest bidder shall be preferred (subject to the undisclosed reserve price) and shall be bound by these Conditions of Sale and shall initially sign a Forestry England Standard Contract or Memorandum of Agreement (dependant on the Vendor of any particular Lot) on the day of the sale. Confirmatory documents will be forwarded to the successful bidder as soon as possible thereafter.
4. The Vendor reserves the right to withdraw Lots or to alter the published order of sale of the Lots. If such changes are made they will be announced by the Auctioneer before the sale commences.
5. The sum by which each offer must exceed the immediately preceding offer shall be at the discretion of the Auctioneer.
6. All Lots will be offered for sale on either a lump sum basis, or a price per cubic metre, or price per tonne, and the auctioneer will invite bids as described on the relevant catalogue page.
7. All bids shall be exclusive of Value Added Tax, which shall be added to the purchase price of each Lot at the appropriate time.
8. At the conclusion of bidding for a Lot, the sealed reserve will be opened and if the last bid equals or exceeds the reserve price, the Lot will be knocked down. A contract is formed when a Lot is declared sold. If the reserve is not reached the Vendor may endeavour, at the conclusion of the Auction and in the sale room, to negotiate a sale with the highest bidder provided the latter gives intimation to this effect.
9. The Auctioneers, David James, shall be the judge of the sale with powers to determine all differences arising during the sale.
10. No Lot carries entitlement to the offer of continuity of supplies of timber outside the Terms and Conditions of the Contract.
11. The description of the trees in the Sale Catalogue is believed to be accurate but is not guaranteed. In all respects the Purchaser is held as satisfying himself as to the description of the sale Lots.
12. Date of commencement of Contracts will be stated in the Special Conditions described with each Lot.
13. Date of completion of Contracts will be stated in the Special Conditions described with each Lot.
14. Payment conditions are as stated in the Forestry England Standard Contract or Memorandum of agreement referred to in 1 above or as otherwise specified by the vendor. Your attention is drawn to the clause in the specimen Forestry England contracts, which describes the normal terms of trading with Forestry England. Application of these terms, which is at the sole discretion of the Vendor is subject to establishment of satisfactory credit worthiness.
15. Arrangements to inspect the timber should be made directly with the appropriate Forester or Agent, as indicated in the Catalogue. Purchasers will be deemed to have acquainted themselves

with arrangements for access and constraints, if any, in respect of each Lot, details of which are also available from the Forester or Agent.

16. Special Conditions of Sale referred to in each Lot are additional to the General or Standard Conditions of Sale. Purchasers are deemed to have acquainted themselves with these Special Conditions whether referred to in the Catalogue or not, details of which are available from the respective Forester or Agent.

17. Latecomers to the Sale will be deemed to have acquainted themselves with the Conditions of Sale and copies of this Catalogue, containing these Conditions, are available in the Saleroom for this purpose.

18. When working purchased lots, safety signs conforming to British Standard BS5378, which warn individuals of a hazard and/or prohibit entry, are to be provided by the Purchaser and maintained to the satisfaction of the Vendor.

19. All users of chainsaws on Vendors' property will be required to hold an appropriate and Certificate of Competence issued by the National Proficiency Tests Council (NPTC) or hold the equivalent modern award issued by LANTRA. Unit awards accredited by the National Council for Vocational Qualification (NCVQ) will be recognised as having a status equivalent to the NPTC Certificates. Self-employed chainsaw operators are responsible for ensuring they acquire the necessary certificates of competence. Timber merchants, management companies, etc., who employ chainsaw operators are responsible for ensuring that those operators are correctly certificated. All chainsaw operators will be required to produce evidence of certification and evidence of compliance with the Forest Industry Safety Accord (FISA) requirements for periodic refresher training (or evidence that any such training need has been registered with FISA).

20. 'Trainees' will be allowed to operate chainsaws on Forestry Commission land for the purpose of gaining post training consolidation, prior to formal NPTC Certification, if they possess a valid Record of Training and Achievement issued by FASTCO. For the purposes of this Condition, a valid Record of Training and Achievement, is one issued post November 1993, and which is still current.

21. The Purchaser will be responsible for ensuring all Young Workers (under 18 years) using chainsaws whether as trainees or qualified operators are supervised and managed in accordance with the Health and Safety Executive's Guidance Note INDG 317.

22. For all contracts, machine operators undertaking operations included within the scope of the Forest Machine Operator Certification Scheme are required to have successfully completed the relevant assessments. Trainee operators will be accepted subject to specific agreement but must be registered with the Scheme.

23. The movement of purchased timber must fully comply with all security and despatch arrangements required by the Vendor and follow the Road Haulage of Round Timber Code of Practice available from the Timber Transport Forum ([www.timbertransportforum.org.uk](http://www.timbertransportforum.org.uk))

24. All Forest England timber sold in this auction is covered by FSC and PEFC certification codes issued by the Soil Association. For private lots please check with the vendor.

Forestry England  
620 Bristol Business Park  
Coldharbour Lane  
Bristol  
BS16 1EJ  
Tel: 0300 067 4000



Lot 8



Lot 19

## **CODE**

### OF ABBREVIATIONS USED WITHIN THIS CATALOGUE

AH	-	Ash
BE	-	Beech
BI	-	Birch
DF	-	Douglas Fir
EL	-	European Larch
HL	-	Hybrid Larch
MB	-	Mixed Broadleaves
NS	-	Norway Spruce
OK	-	Oak
PO	-	Poplar
RC	-	Western Red Cedar
RSQ	-	Coast Redwood
SC	-	Sweet Chestnut
SY	-	Sycamore
WH	-	Western Hemlock

---

Vol (OB)	-	Volume overbark
Vol (UB)	-	Volume underbark
td (UB)	-	Top diameter underbark
Cl	-	Clearfell
cm	-	Centimetre
Cu.m or m <sup>3</sup>	-	Cubic Metre
m	-	Metre
DBH	-	Diameter at breast height
SS	-	Sampling scheme
S	-	Step
M	-	Method
CF	-	Clearfell
FAS	-	Felled at stump
GF	-	Group felling
SF	-	Selective felling
STH	-	Selective thinning
SWL	-	Sawlogs
SSWL	-	Short sawlogs
TH	-	Thinnings

## **PLANS**

Where appropriate the plans in these particulars have been based upon the Ordnance Survey Map with the sanction of the Controller of H M Stationery Office. Crown Copyright reserved.

The plans are produced for convenience only and, although believed to be correct, accuracy is not guaranteed. Prospective purchasers are strongly advised to contact the appropriate office/agent when wishing to locate the site exactly from the plan.

A geographical distribution map of the Lots may be found within this Catalogue.







**SOFTWOOD PARCELS**

<b><u>LOT</u></b>	<b>WOOD/FOREST LOCATION</b>	<b>BRIEF DESCRIPTION</b>	<b>SPECIES IN LOT</b>	<b>VOL (M<sup>3</sup>) (OBF)</b>	<b>AV. DBH MEAN TREE</b>	<b>AGENT/FORESTER IN CHARGE</b>	<b>TEL NO</b>
21	Lynford/Snake Woods, Mundford, Norfolk	SWL	DF	141.94 – 26 logs		Andrew Whistler	07785 953564
22	West Tofts, Mundford, Norfolk	SWL	EL	131.47		Andrew Whistler	07785 953564
23	Ringwood, Verwood	SWL	DF	46.21 – 13 logs		Jonathan Stocks	07710 748411
24	Blaize Bailey, Forest of Dean	SWL	RSQ	51.98		Simon McGrath	07795 612842
25	Blaize Bailey, Forest of Dean	SWL	EL	150.21		Simon McGrath	07795 612842
26	Blaize Bailey, Forest of Dean	SWL	EL	46.45		Simon McGrath	07795 612842
27	Blaize Bailey, Forest of Dean	SWL	EL	57.01		Simon McGrath	07795 612842
28	Blaize Bailey, Forest of Dean	SWL	EL	65.66		Simon McGrath	07795 612842

APPROXIMATE GEOGRAPHICAL LOCATION OF LOTS

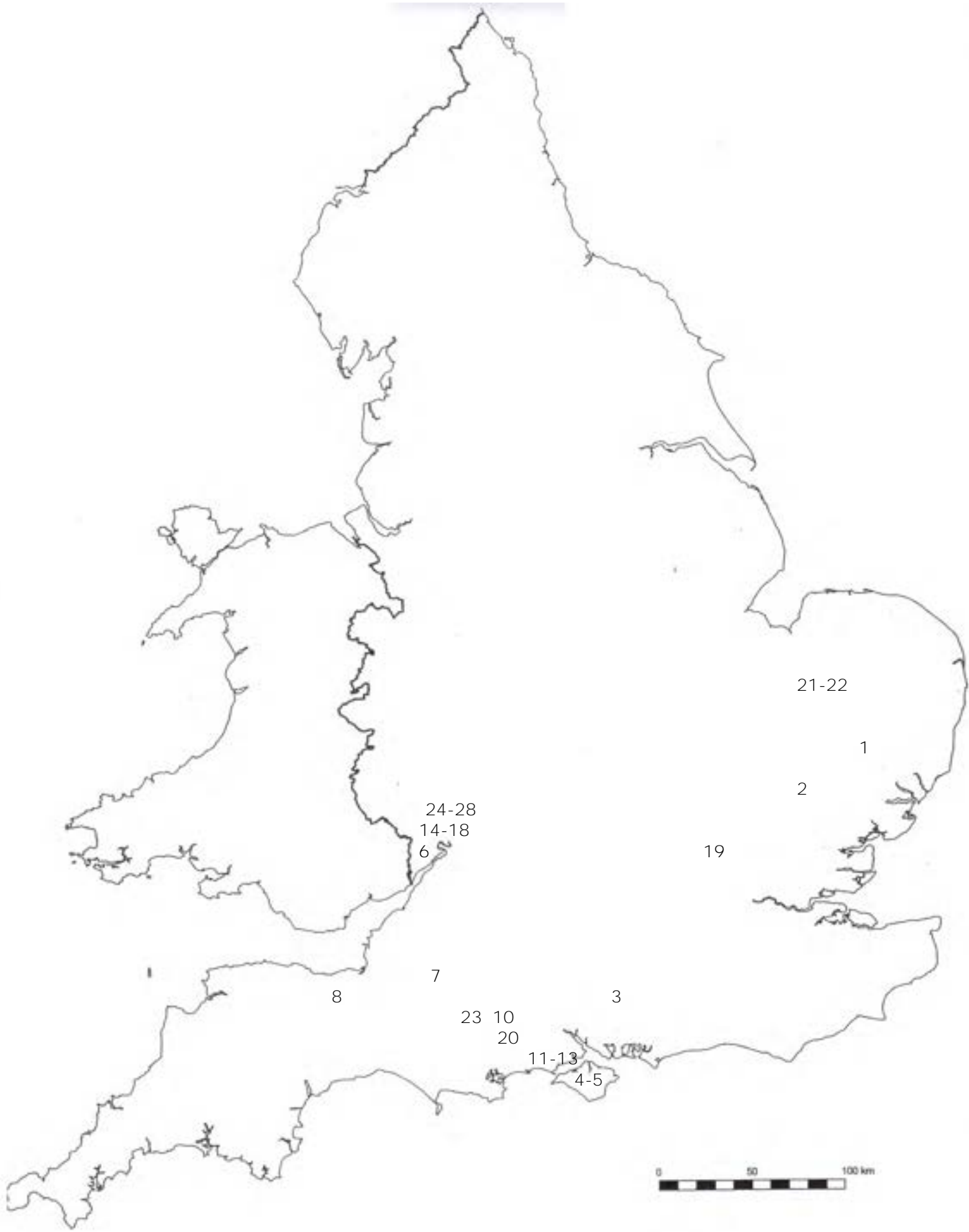

**LOT 1****WOOD**

Lineage Wood, Nr Lavenham

**DESCRIPTION**Hardwood standing sale by volume  
(Thinning)**AGENT RESPONSIBLE**Stephen Whall  
Forestry England, Tangham Office  
East England  
Email:  
Stephen.whall@forestryengland.uk  
Tel: 07747 269371**REF:** F55320

Species	Number of trees	Estimated volume (m3 overbark)	Estimated weight (tonnes)	Mean tree size (m3)	Dbh (cm)	Measurement procedure
Beech	422	589.40	545.74	1.40	41	Tariff method A5
Oak	208	112.80	107.43	0.54	27	Tariff method A5
<b>Totals</b>	<b>630</b>	<b>702.20</b>	<b>653.17</b>	<b>1.11</b>		

**VIEWING ARRANGEMENTS**

By appointment during normal working hours. Contact above to arrange.

**SPECIAL CONDITIONS**

1. Contract period from: 11/12/2023 to 29/11/24
2. Contract Schedules and maps available from above address.

**PAYMENT**

Two equal instalments due on 11/12/23 and 01/05/24

Payment required in advance of cutting. Forestry England may also charge a 10% deposit depending on the Purchaser's status. See the clauses in sections 12.13 to 12.15 of Forestry England's standard conditions for the sale of standing trees and other products to be harvested.

**METHOD OF MARKING**

Orange/ Pink paint

**BIDDING**

Bids will be taken on a lump sum basis.

# Site Plan

Lot 1

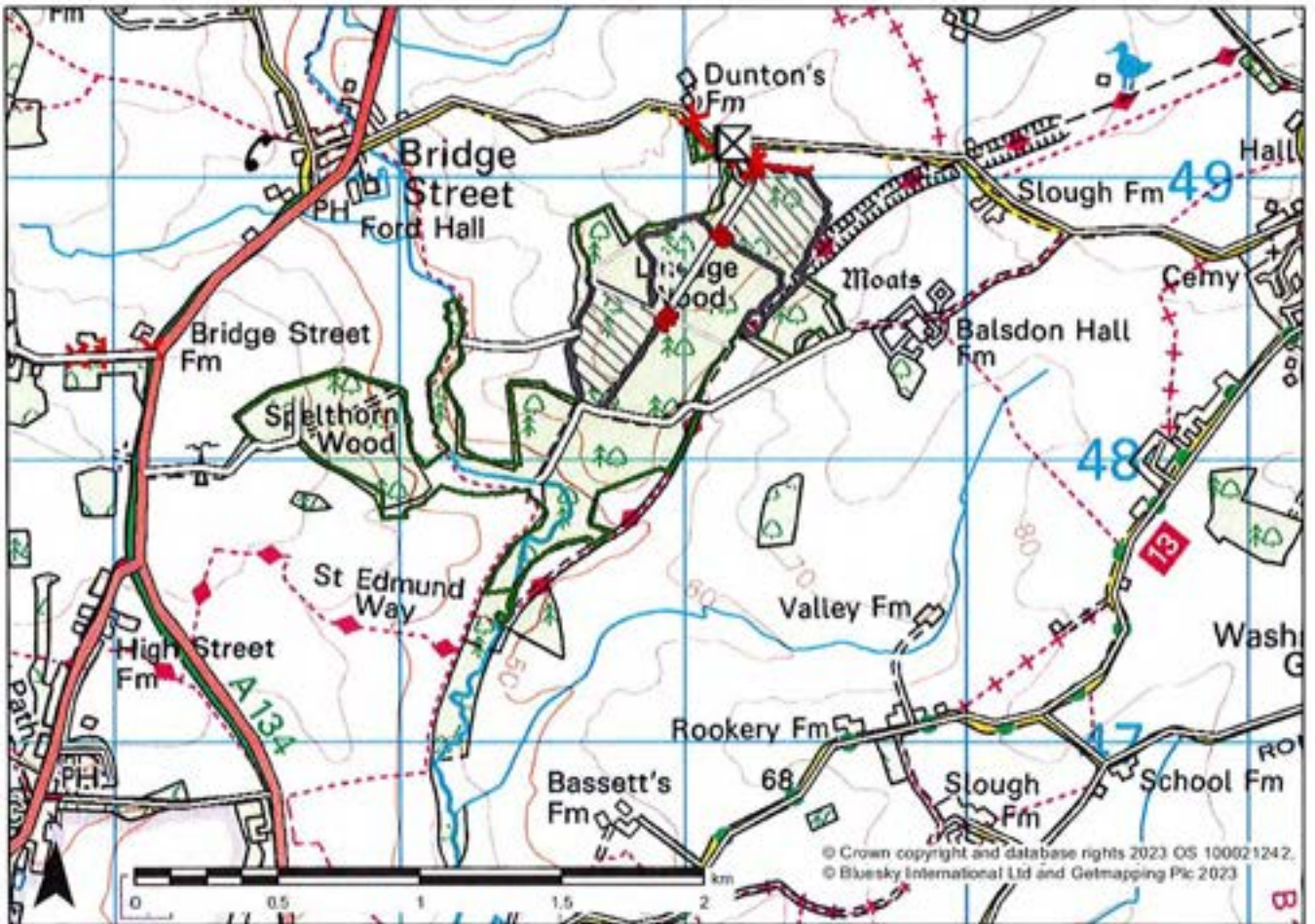

## Legend

Gated/Cattle Grids/Barriers	Fences	Hardwood Auction Site Plan (Eng)	Secondary Roads (GB)
Gated/Cattle Grids/Barriers	Fences	Hardwood Auction Site Plan (Eng)	Secondary Roads (GB)
Timber Stacking Sites	Electricity Powerlines	Blocks	Minor Roads (GB)
Timber Stacking Sites	Overhead powerline	Blocks	Minor Roads (GB)
Forest Roads	Underground powerline	Main Roads (GB)	
Forest Roads		Main Roads (GB)	

## Notes

Contract No: F55320

Grid Ref: TL 8905 4864

Site Name: Lineage Hardwood map 23/24

### Access Information:

From the A134 at Bridge Street, head East towards Lavenham. After about a mile the entrance to the wood will be located on the right, just before Lineage Wood Cottages.



## LOT 2

### WOOD

Ditton Wood, Nr Woodditton

### DESCRIPTION

Hardwood standing sale by volume  
(Thinning)

### AGENT RESPONSIBLE

Stephen Whall  
Forestry England, Tangham Office  
East England  
Email:  
Stephen.whall@forestryengland.uk  
Tel: 07747 269371

**REF:** F55321



Species	Number of trees	Estimated volume (m3 overbark)	Estimated weight (tonnes)	Mean tree size (m3)	Dbh (cm)	Measurement procedure
Ash	416	171.20	119.72	0.41	25	Tariff method A5
Beech	103	64.10	59.35	0.62	32	Tariff method A5
Oak	812	784.90	747.52	0.97	31	Tariff method A5
<b>Totals</b>	<b>1331</b>	<b>1020.20</b>	<b>926.60</b>	<b>0.77</b>		

### VIEWING ARRANGEMENTS

By appointment during normal working hours. Contact above to arrange.

### SPECIAL CONDITIONS

1. Contract period from: 11/12/2023 to 29/11/24
2. Contract Schedules and maps available from above address.

### PAYMENT

Two equal instalments due on 11/12/23 and 01/05/24

Payment required in advance of cutting. Forestry England may also charge a 10% deposit depending on the Purchaser's status. See the clauses in sections 12.13 to 12.15 of Forestry England's standard conditions for the sale of standing trees and other products to be harvested.

### METHOD OF MARKING

Orange/ Pink paint

### BIDDING

Bids will be taken on a lump sum basis.

# Site Plan

Lot 2

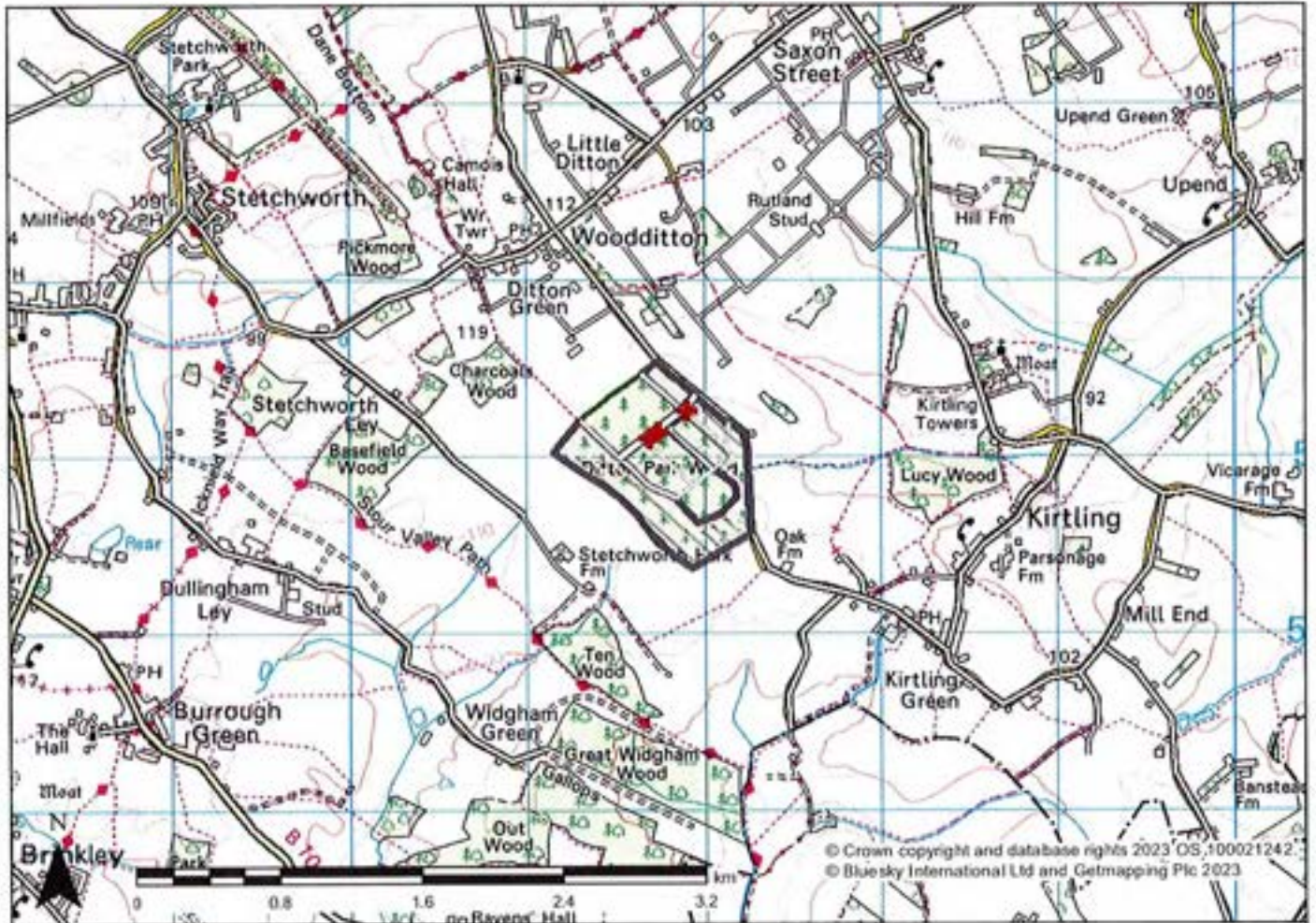

Legend	
Timber Staking Sites	Timber Staking Sites
Forest Roads	Forest Roads
Hardwood Auction Site Plan (Eng)	Hardwood Auction Site Plan (Eng)
Blocks	Blocks
Secondary Roads (GB)	Secondary Roads (GB)
Moor Roads (GB)	Moor Roads (GB)

## Notes

Contract No: F55321

Grid Ref: TL 6670 5695

Site Name: Ditton Hardwood 23/24

### Access Information:

Leave Newmarket along Woodditton Road heading SE which turns into Vicarage Lane. At the crossroads in Ditton Green continue straight onto Kirtling road heading towards Kirtling. The entrance to Ditton Wood will be located on the right in just under 1 mile



## LOT 3

### WOOD

Wildham & Inholmes Woods,  
Chichester.

### DESCRIPTION

Hardwood standing sale by weight  
(Thinning & Clearfell)

### AGENT RESPONSIBLE

Simon Woodcock  
Forestry England, Lyndhurst Office.  
South England Forest District.  
Email:  
simon.woodcock@forestryengland.uk  
Tel: 07425 635796

**REF:** F55118



Species	Number of trees	Estimated volume (m3 overbark)	Estimated weight (tonnes)	Mean tree size (m3)	Dbh (cm)	Measurement procedure
Beech	5771	8663.3	8021.57	1.49	42	Tariff method A5 & B6. Details to be confirmed.
Western Red Cedar	468	582.1	454.77	1.24	55	Tariff Method A4
<b>Totals</b>	<b>6239</b>	<b>9245.40</b>	<b>8476.34</b>	<b>1.48</b>		

### VIEWING ARRANGEMENTS

By appointment during normal working hours.

### SPECIAL CONDITIONS

1. Contract period from 11/12/2023 to 30/11/2024
2. Contract Schedules and maps available from above address.

### PAYMENT

Payment required within 30 days of invoice. The Forestry Commission may also charge a 10% deposit depending on the Purchaser's status.

### METHOD OF MARKING

Orange paint.

### BIDDING

Bids will be taken on a price per tonne basis



# Site Plan

Lot 3

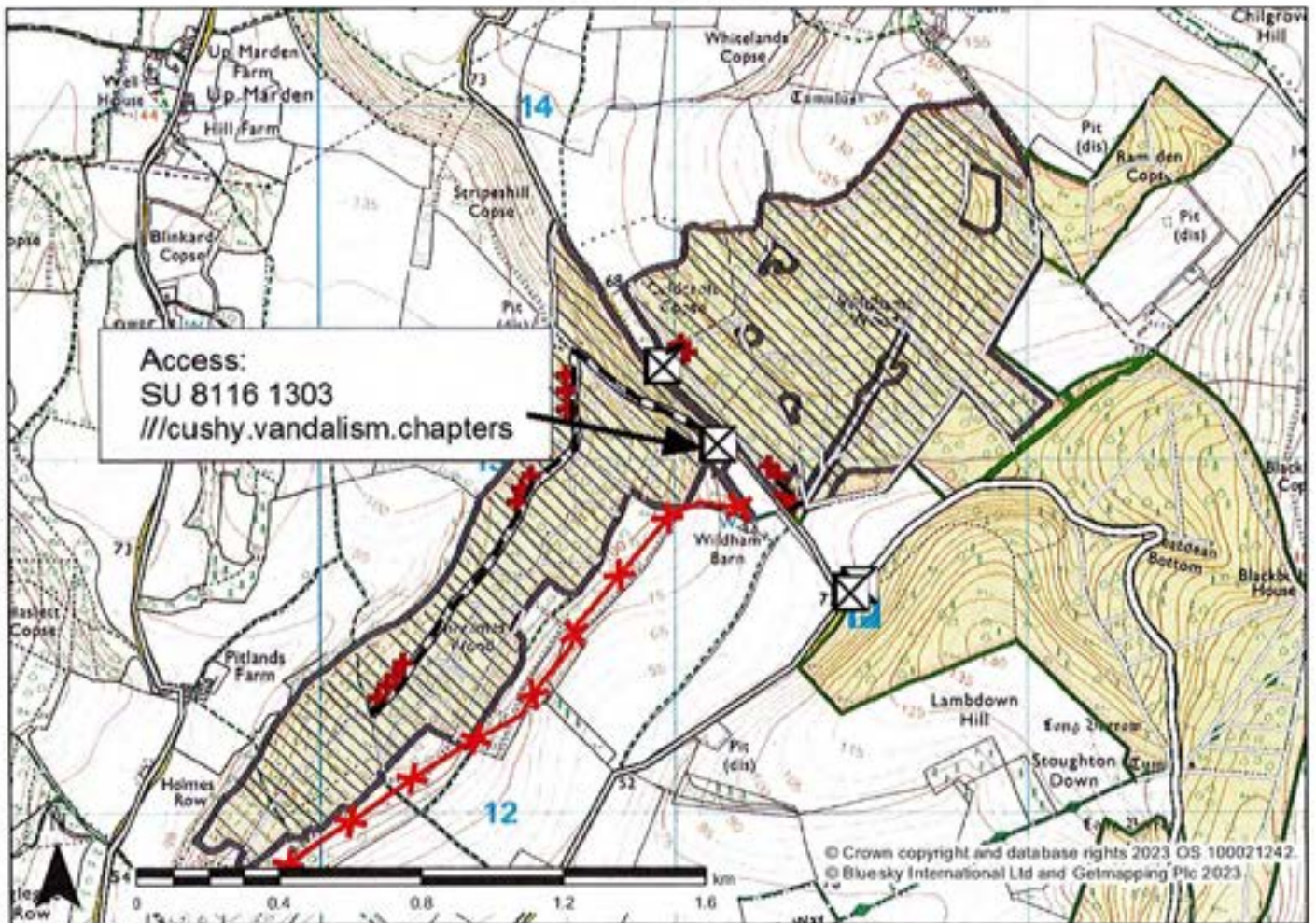

Access:  
SU 8116 1303  
//cushy.vandalism.chapters

Legend	
Gates/Cattle Grids/Barriers	Forest Roads
Timber Stacking Sites	Rides
Gates/Cattle Grids/Barriers	Electricity Powerlines
Timber Stacking Sites	Underground powerline
	Hardwood Auction Site Plan (Eng.)
	Hardwood Auction Site Plan (Eng.)
	Blocks
	Blocks

## Notes

Contract No: F55118

Grid Ref: SU 8085 1292

Site Name: Wildham & Inholmes,  
Chichester

### Access Information:

From the village of Stoughton head north east for 1.5 miles and Inholmes will be on your left hand side and Wildham wood on your right. Both woodlands have Forestry England signs are accessed through a metal barrier on a gravel road. Both gates have combination locks, please request the combination before travelling. Nearest postcode is PO18 9JG.



## LOT 4

### WOOD

Parkhurst, Isle of Wight

### DESCRIPTION

Hardwood standing sale by volume  
(Clearfell & Thinning)

### AGENT RESPONSIBLE

Jonathan Stocks  
Forestry England, Lyndhurst Office.  
South England Forest District.

Email:

Jonathan.stocks@forestryengland.uk

Tel: 07710748411

REF: F55285



Species	Number of trees	Estimated volume (m3 overbark)	Estimated weight (tonnes)	Mean tree size (m3)	Dbh (cm)	Measurement procedure
OK	179	327.00	311.43	1.82	49	Tariff method A5
BE	182	174.00	161.11	0.95	37	Tariff Method A5
<b>Totals</b>	<b>361</b>	<b>501.00</b>	<b>472.54</b>			

### VIEWING ARRANGEMENTS

By appointment during normal working hours.

### SPECIAL CONDITIONS

1. Contract period from 11/12/2023 to 28/06/2024.
2. Contract Schedules and maps available from above address.
3. All felling must be completed by 31/03/2023.
4. All cordwood is included within the sale.

### PAYMENT

Two instalments due on 11/12/2022 and 13/02/2024.

Payment required in advance of cutting. Forestry England may also charge a 10% deposit depending on the Purchaser's status. See the clauses in sections 12.13 to 12.15 of Forestry England's standard conditions for the sale of standing trees and other products to be harvested.

### METHOD OF MARKING

Orange paint.

### BIDDING

Bids will be taken on a lump sum basis.

# Site Plan

Lot 4

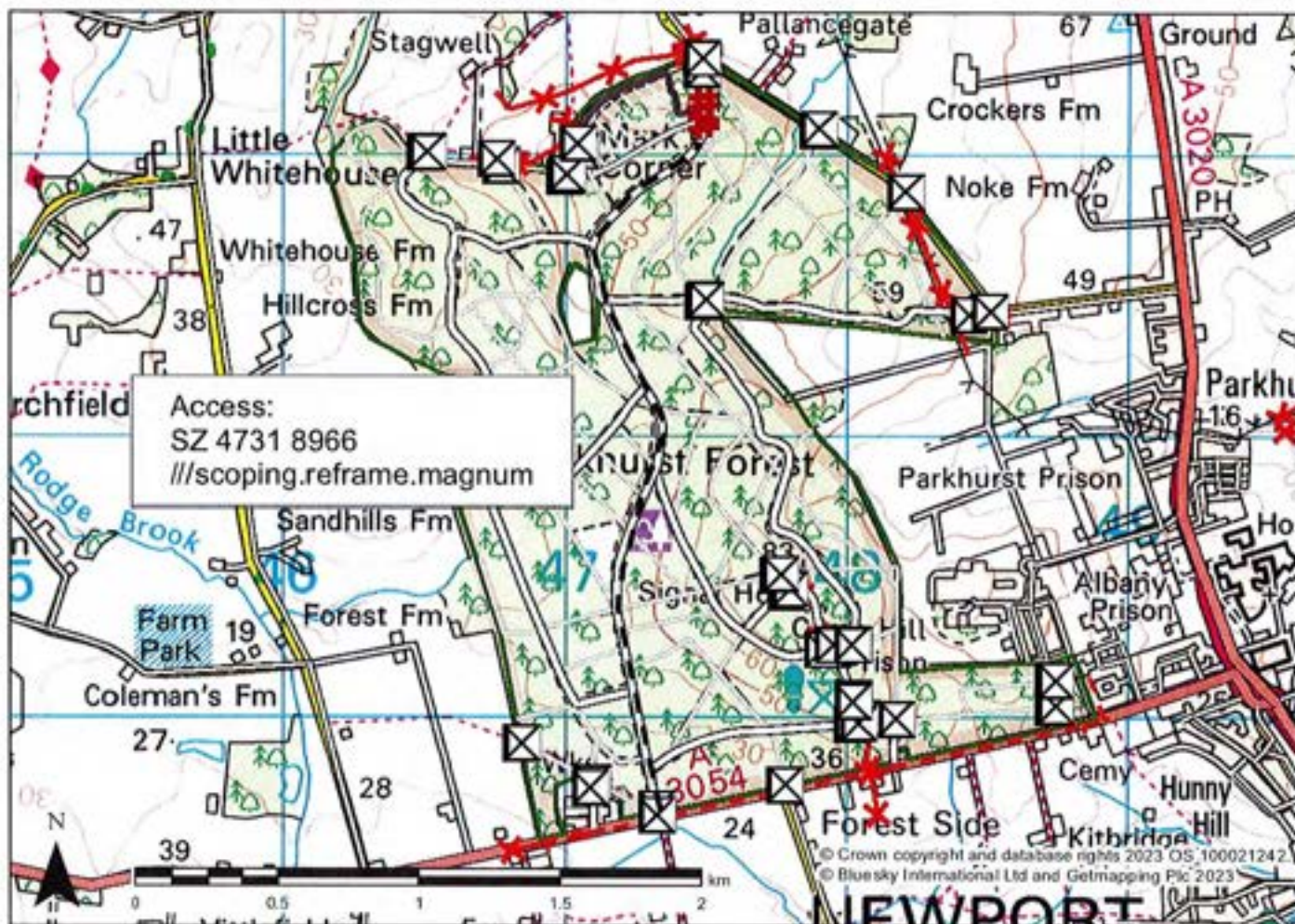

Legend

Gates/Cattle Grids/Barriers	Rides	Hardwood Auction Site Plan (Eng.)	Minor Roads (GB)
Timber Stacking Sites	Electricity Powerlines	Blocks	Minor Roads (GB)
Timber Stacking Sites	Overhead powerlines	Blocks	
Forest Roads	Underground powerlines	Main Roads (GB)	

## Notes

Contract No: F55285

Grid Ref: SZ 4727 9210

Site Name: Parkhurst Isle of Wight

### Access Information:

Access is from Tuckers Gate, A5304 Forest Road, Newport (standard FC key). Nearest postcode is PO30 5YS the entrance is at W3W://scoping.reframe.magnum



## LOT 5

### WOOD

Brighstone, Isle of Wight.

### DESCRIPTION

Standing Hardwood by volume.  
Standing Sale of dead and dying Ash.

### AGENT RESPONSIBLE

Ben Phelan  
Forestry England, Lyndhurst office.  
South England Forest District.

Email:

Ben.phelan@forestryengland.uk

Tel: 07920 576537

REF: F55286



Species	Number of trees	Estimated volume (m3 overbark)	Estimated weight (tonnes)	Mean tree size (m3)	Dbh (cm)	Measurement procedure
Ash	971	537	-	0.55	30	Estimate only, based on B6 sampling in 8 plots of 0.05ha each.
<b>Totals</b>	<b>971</b>	<b>537.00</b>		<b>0.55</b>		

### VIEWING ARRANGEMENTS

By appointment during normal working hours.

### SPECIAL CONDITIONS

1. Contract period from start date 11/12/2023 to end date 04/11/2024
2. Contract Schedules and maps available from above address.
3. **Machine felling is strongly recommended for this site due to the nature of the work.**
3. All cordwood to 7cm TDUB is included in the sale and must be removed from site.
4. Fallen trees and dead wood within the area is not included in the estimated volume, but may be recoverable and is included in the sale.

### PAYMENT

Two instalments due on 11/12/2023 and 28/02/24.

Payment required in advance of cutting. Forestry England may also charge a 10% deposit depending on the Purchaser's status. See the clauses in sections 12.13 to 12.15 of Forestry England's standard conditions for the sale of standing trees and other products to be harvested.

### METHOD OF MARKING

Paint colour to be confirmed.

### BIDDING

Bids will be taken on a lump sum basis.

# Site Plan

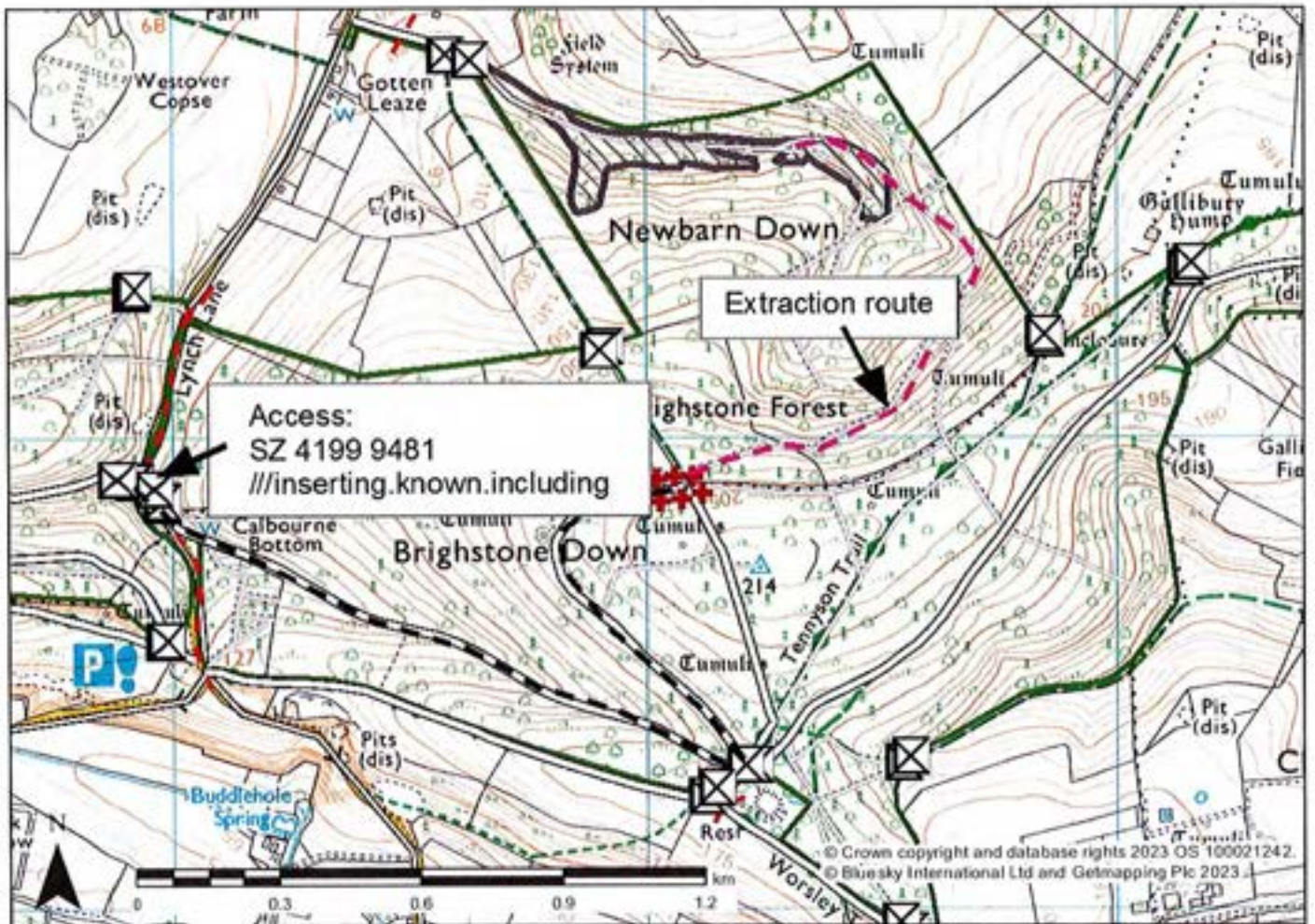

**Legend**

Gates/Cattle Grids/Barriers	Forest Roads	Overhead powerline	Hardwood Auction Site Plan (Eng.)
Timber Stacking Sites	Rides	Underground powerline	Blocks

## Notes

Contract No: F55286

Grid Ref: SZ 4307 8563

Site Name: Brighstone, Isle of Wight

**Access Information:**

Access is through a metal barrier on the eastern side of Lynch Lane between Brighstone and Calbourne. The nearest postcode is PO30 4JH. The barrier has a combination lock- please request number before travelling.



## LOT 6

### WOOD

Piano Corner West, Brierley – Forest of Dean

### DESCRIPTION

Hardwood standing sale by weight (Thinning & Clearfell)

### AGENT RESPONSIBLE

James Williams  
FC Coleford  
West England Forest District  
James.williams@forestryengland.uk  
Tel: 07899 913928

REF: F55318



Species	Number of trees	Estimated volume (m3 overbark)	Estimated weight (tonnes)	Mean tree size (m3)	Dbh (cm)	Measurement procedure
OK	1494	790.00	752.38	0.53	28	Tariff method A5
OK	64	235.00	223.81	3.67	75	Tariff method A5
BE	18	66.00	61.11	3.67	75	Tariff method A5
MB	160	36.00	36	0.23	21	Tariff method A5
NS	93	94.00	78.33	1.01	33	Tariff method A4
NS	44	64.00	53.33	1.45	40	Tariff method A4
HL	102	179.00	131.62	1.75	45	Tariff method A4
HL	129	199.00	146.32	1.54	40	Tariff method A4
RC	103	153.00	119.53	1.49	55	Tariff method A4
RC	73	98.00	76.56	1.34	50	Tariff method A4
WH	70	153.00	125.41	2.19	54	Tariff method A4
<b>Totals</b>	<b>2350</b>	<b>2067.00</b>	<b>1804.41</b>	<b>0.88</b>		

### VIEWING ARRANGEMENTS

By appointment during normal working hours.

### SPECIAL CONDITIONS

1. Contract period from 08/01/24 to 20/12/24
2. Bidders **must** contact the contract manager for the contract schedules, site constraints and maps.
3. Please note the timing of work will be significantly affected by a high voltage overhead powerline.
4. Working to racks and high standards of workmanship are mandatory given the local interest.

### PAYMENT

Payment required within 30 days of invoice. The Forestry Commission may also charge a 10% deposit depending on the Purchaser's status.

### METHOD OF MARKING

Orange paint spots

### BIDDING

Bids will be taken on a price per tonne basis.

# Site Plan

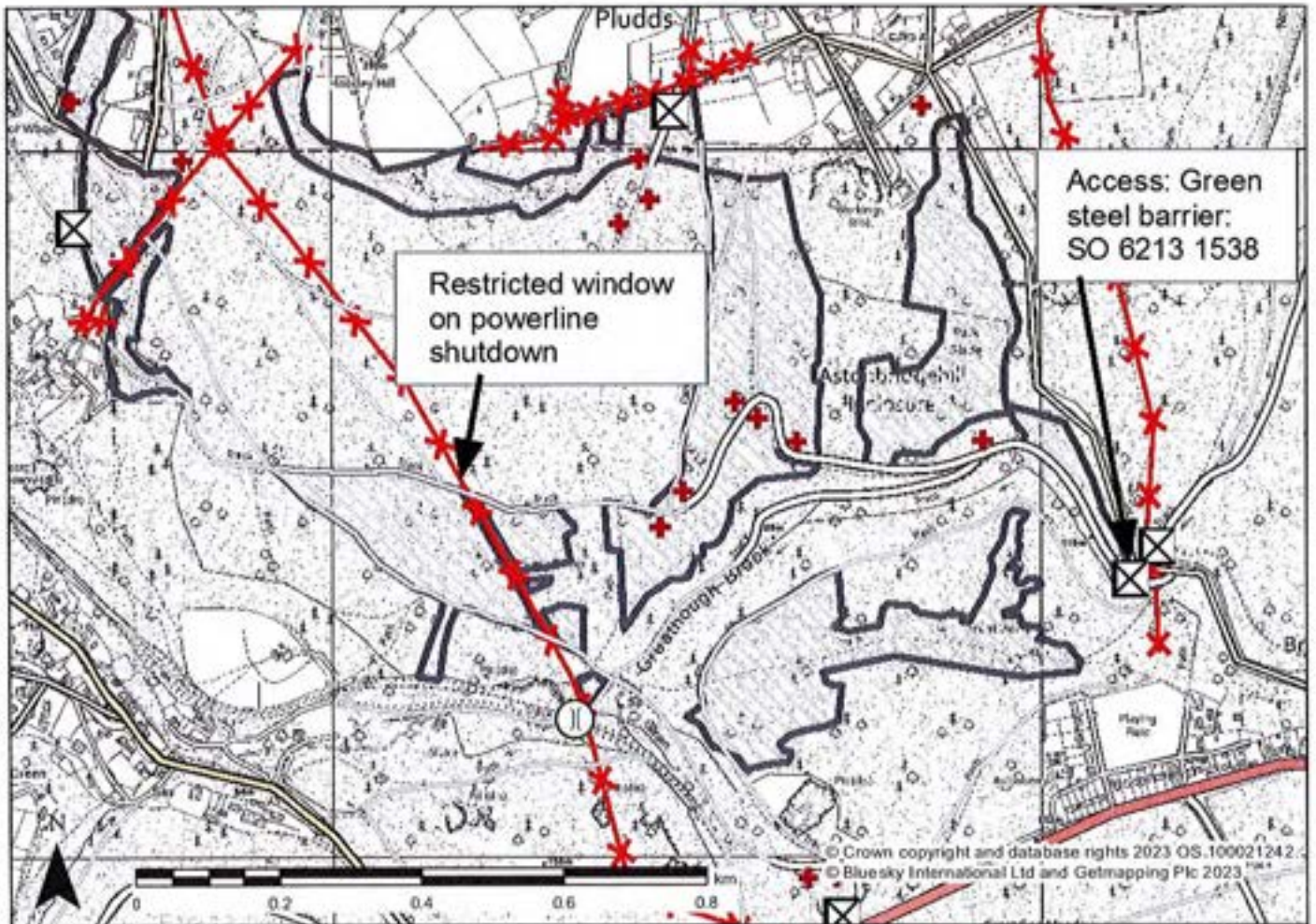

**Legend**

Gates/Cattle Grids/Barriers	Forest Roads	Hardwood Auction Site Plan (Eng.)	Minor Roads (GB)
Timber Stacking Sites	Rides	Hardwood Auction Site Plan (Eng.)	Minor Roads (GB)
Timber Stacking Sites	Rides	Main Roads (GB)	
Bridges	Electricity Powerlines	Secondary Roads (GB)	
Bridges	Overhead powerline	Secondary Roads (GB)	
	Underground powerline		

## Notes

Contract No:  
  
Grid Ref: SO 6137 1566  
  
Site Name: Piano Corner West

**Access Information:**  
Driving east on the A4136, pass the petrol station in Brierley on your left, drop down the hill then take the first left signed for The Pludds. Access through the padlocked green steel barrier on your left after 1/4 mile.



## LOT 7

### WOOD

Wanstrow Wood, Wanstrow,  
Somerset

### DESCRIPTION

Thinning and Clearfell of Ash, Oak  
and Poplar

### AGENT RESPONSIBLE

Tom Pascall  
Fountains Forestry  
Court Barn  
Highfield Farm, Clyst Road,  
Topsham  
Exeter, EX3 0BY

[tom.pascall@fountainsforestry.co.uk](mailto:tom.pascall@fountainsforestry.co.uk)

Tel: 07436 229188



Species	Area of trees	Estimated volume (m3 overbark)	Estimated weight (tonnes)	Mean tree DBH (cm3)	Dbh (cm)	Measurement procedure
OK, AH	2.57 ha.	90	98	28		
PO	0.43 ha	148	99	45		
AH	2.1 ha	102	108	57		
OK, AH	19.31 ha	740	787	29		
<b>Totals</b>	<b>24.41 ha</b>	<b>1080</b>	<b>1092</b>			

### VIEWING ARRANGEMENTS

By appointment during normal working hours.

### SPECIAL CONDITIONS

1. Contract period from 29/07/2024 to 30/09/2024
2. Contract Schedules and maps available from above address.

### PAYMENT

Payment within 30 days of uplift - £5,000 deposit required prior to date of commencement of contract date.

### GENERAL CONDITIONS

1. Estimated 75% Ash and 25% Oak plus clearfell Poplar
2. Access across railway line with phone on either side – crossing clearance must be confirmed by the operator.
3. Construct and improvement of loading bay and lorry bay/turn at purchaser's expense (material will need to be imported).
4. Lop and top arising from under story to be chipped or left lying flat (windrowed in clearfell).
5. Reinstatement to be completed post-harvest.
6. Details from agent responsible (above).

### METHOD OF MARKING

Sample marking with orange spots.

### BIDDING

Bids will be taken on a price per tonne basis



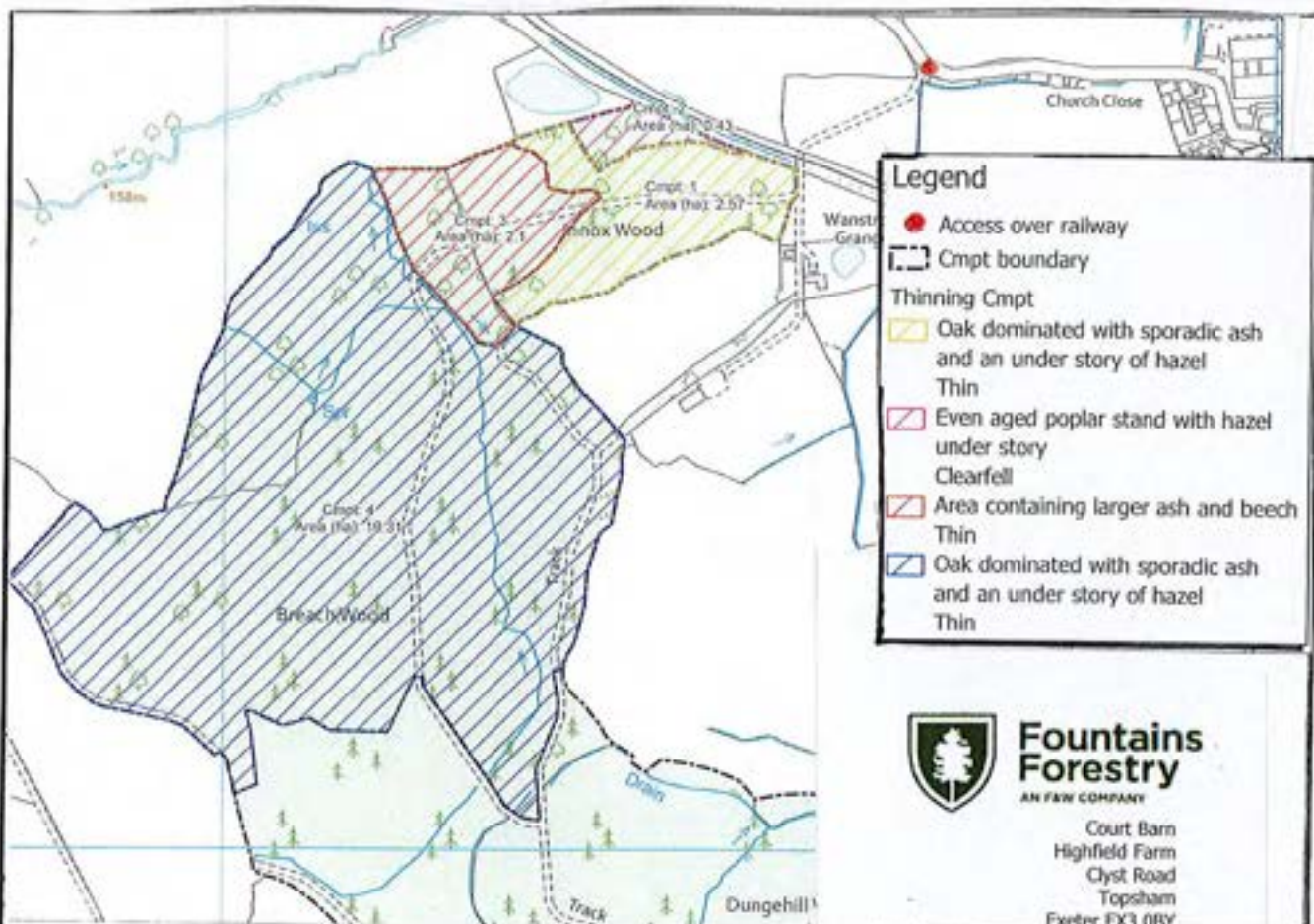

**Legend**

- Access over railway
- ▭ Cmpt boundary
- Thinning Cmpt
  - ▨ Oak dominated with sporadic ash and an under story of hazel Thin
  - ▨ Even aged poplar stand with hazel under story Clearfell
  - ▨ Area containing larger ash and beech Thin
  - ▨ Oak dominated with sporadic ash and an under story of hazel Thin

**Fountains Forestry**  
 AN F&W COMPANY  
 Court Barn  
 Highfield Farm  
 Chyst Road  
 Topsham  
 Exeter EX3 0BY

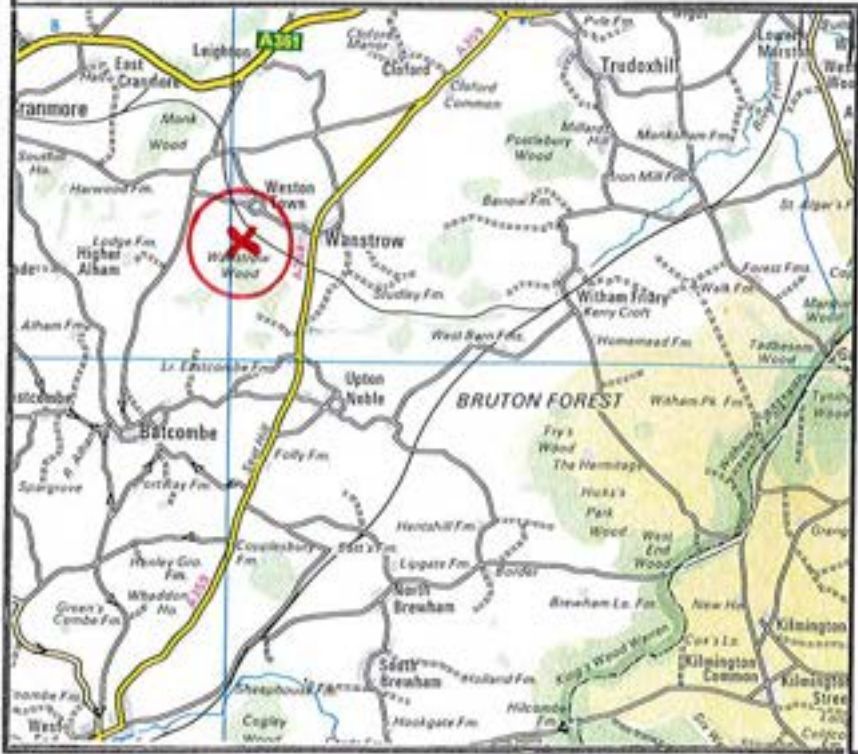

**Notes**

Grid Ref: \_\_\_\_\_

Access Information: \_\_\_\_\_

**LOT 8**

**WOOD**

Keepers Combe – Great Wood – Nr  
Bridgwater

**DESCRIPTION**

Conifer standing sale by volume  
(Thinning)

**AGENT RESPONSIBLE**

Owen Meredith Forestry England –  
Exmoor & Quantocks West England  
Forest District  
Owen.meredith@forestryengland.uk  
Tel: 07867 553101

**REF:** F55309



Species	Number of trees	Estimated volume (m3 overbark)	Estimated weight (tonnes)	Mean tree size (m3)	Dbh (cm)	Measurement procedure
DF	24	196.72	149.03	8.20	84	Tariff method – A4
<b>Totals</b>	<b>24</b>	<b>196.72</b>	<b>149.03</b>	<b>8.20</b>		

**VIEWING ARRANGEMENTS**

By appointment during normal working hours.

**SPECIAL CONDITIONS**

1. Contract period from 15/01/2024 to 29/03/2024.
2. Contract Schedules and maps available from above address.

**PAYMENT**

Two equal instalments due on 15/01/2024 and 01/02/2024

Payment required in advance of cutting. Forestry England may also charge a 10% deposit depending on the Purchaser's status. See the clauses in sections 12.13 to 12.15 of Forestry England's standard conditions for the sale of standing trees and other products to be harvested.

**METHOD OF MARKING**

Red numbers - paint.

**BIDDING**

Bids will be taken on a lump sum basis.

# Site Plan

Lot 8

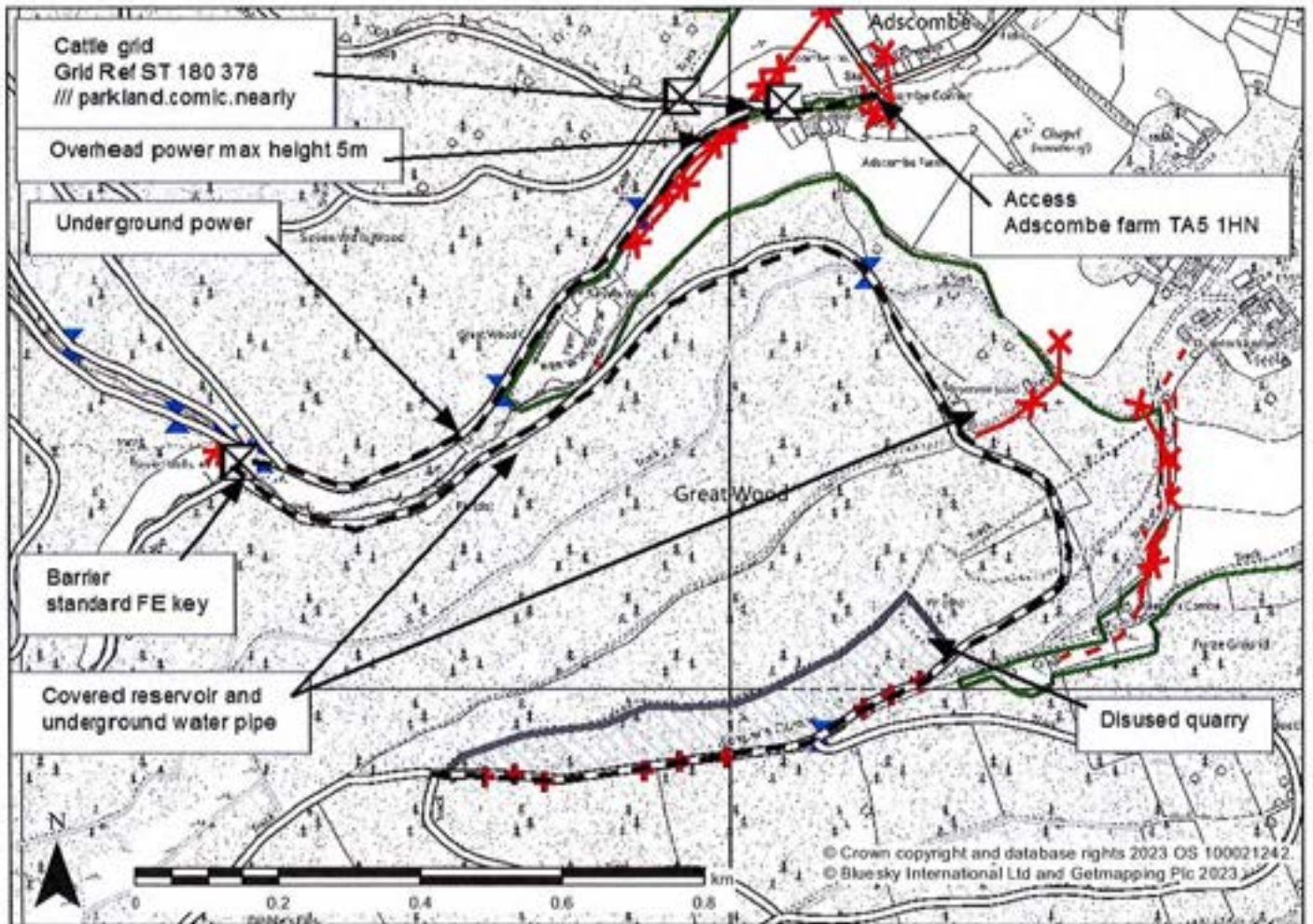

**Legend**

<b>Gates/Cattle Grids/Barriers</b>	<b>Rides</b>	<b>Culverts</b>	<b>Minor Roads (GB)</b>
Gates/Cattle Grids/Barriers	Rides	Culverts	Minor Roads (GB)
<b>Timber Stacking Sites</b>	<b>Electricity Powerlines</b>	<b>Hardwood Auction Site Plan (Eng)</b>	
Timber Stacking Sites	Overhead powerlines	Hardwood Auction Site Plan (Eng)	
<b>Forest Roads</b>	Underground powerlines	<b>Blocks</b>	
Forest Roads		Blocks	

## Notes

Contract No:

Grid Ref: ST 1795 3700

Site Name: Great Wood, Keepers Combe

**Access Information:**

Leave A39 at Cottage Inn TA5 1HZ.  
Straight over cross roads, then second left to Adcombe/Ramscombe.



**LOT 10**

**WOOD**

Ringwood, Nr Verwood

**DESCRIPTION**

Hardwood logs at roadside by Volume

**AGENT RESPONSIBLE**

Jonathan Stocks  
Forestry England, Lyndhurst Office.  
South England Forest District.

Email:

Jonathan.stocks@forestryengland.uk

Tel: 07710748411

REF: F55287



Species	Number of logs	Estimated Quantity	Unit	Measurement procedure
OK	70	49.88	M3obf	Length and mid-diameter under bark
BE	12	10.93	M3obf	Length and mid-diameter under bark
ASH	5	3.72	M3obf	Length and mid-diameter under bark
<b>Totals</b>	<b>87</b>	<b>64.53</b>		

**VIEWING ARRANGEMENTS**

By appointment during normal working hours. A log list will be available from the agent from 27/10/2023.

**SPECIAL CONDITIONS**

1. Contract period from 11/12/2023 to 28/06/2024
2. Contract Schedules and maps available from above address.

**PAYMENT**

One instalment due on 11/12/2023

Payment is required before uplift unless the Purchaser has sufficient credit with Forestry England. Forestry England may also charge a 10% deposit depending on the Purchaser's status. See the clauses in sections 13.13 to 13.15 of Forestry England's Standard Conditions for Forest Products.

**METHOD OF MARKING**

Timber Tags

**BIDDING**

Bids will be taken on a price per cubic metre over bark basis.

# Site Plan

Lot 10

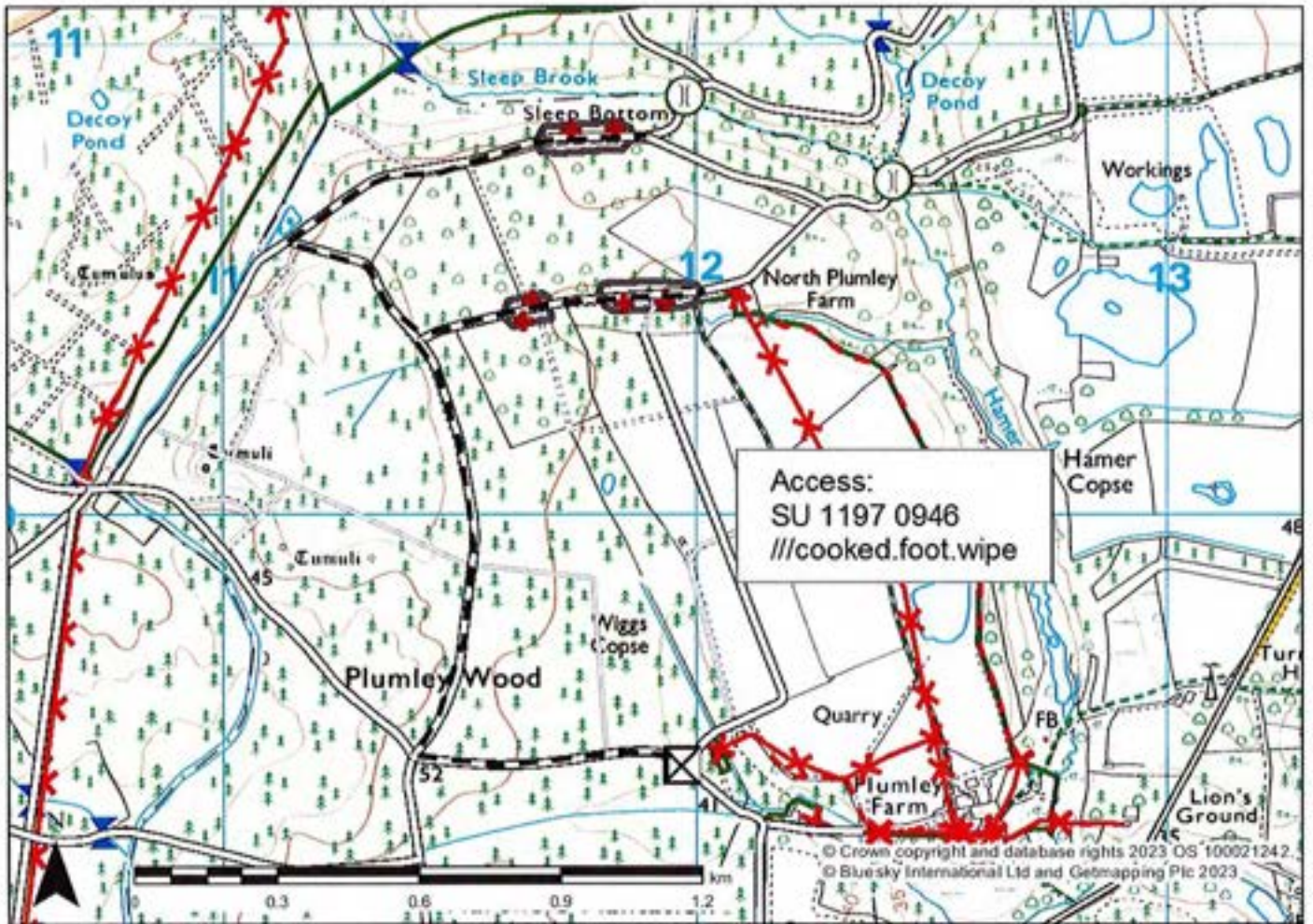

**Legend**

Gates/Cattle Grids/Barriers	Forest Roads	Culverts	Minor Roads (GB)
Timber Stacking Sites	Rides	Hardwood Auction Site Plan (Eng)	Minor Roads (GB)
Bridges	Electricity Powerlines	Blocks	
	Overhead powerline		
	Underground powerline		

## Notes

Contract No: F55287

Grid Ref: SU 1180 1061

Site Name: Ringwood Nr Verwood

### Access Information:

Access off A31 along B3081 turning right on to Alderholt Rd towards turn off to gravel road at //happen.army.highlighted. Continue north towards forest gate access (standard FC key) at //cooked.foot.wipe. Nearest postcode BH24 3OB.



**LOT 11****WOOD**

Parkhill, Nr Brockenhurst

**DESCRIPTION**

Hardwood logs at roadside by Volume

**AGENT RESPONSIBLE**Jonathan Stocks  
Forestry England, Lyndhurst Office.  
South England Forest District.

Email:

Jonathan.stocks@forestryengland.uk

Tel: 07710748411

REF: F55290



Species	Number of logs	Estimated Quantity	Unit	Measurement procedure
OK	103	167.67	M3obf	Length and mid-diameter under bark
<b>Totals</b>	<b>103</b>	<b>167.67</b>		

**VIEWING ARRANGEMENTS**

By appointment during normal working hours. A log list will be available from the agent from 10/11/2023.

**SPECIAL CONDITIONS**

1. Contract period from 11/12/2023 to 28/06/2024
2. Contract Schedules and maps available from above address.

**PAYMENT**

One instalment due on 11/12/2023

Payment is required before uplift unless the Purchaser has sufficient credit with Forestry England. Forestry England may also charge a 10% deposit depending on the Purchaser's status. See the clauses in sections 13.13 to 13.15 of Forestry England's Standard Conditions for Forest Products.

**METHOD OF MARKING**

Timber Tags

**BIDDING**

Bids will be taken on a price per cubic metre over bark basis.

# Site Plan

Lot 11

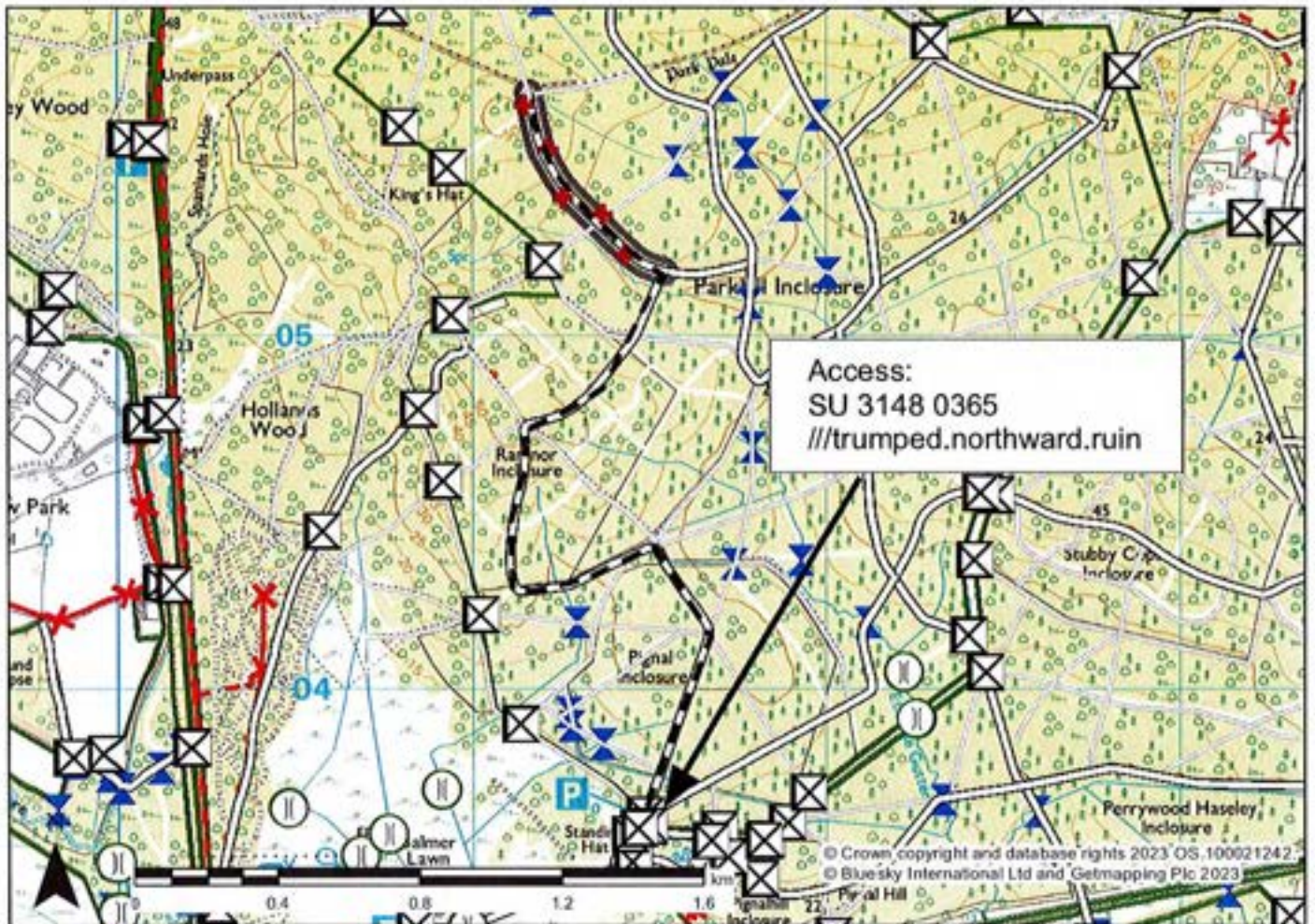

Legend			
Gates/Cattle Grids/Barriers	Forest Roads	Culverts	Main Roads (GB)
Gates/Cattle Grids/Barriers	Rides	Culverts	Main Roads (GB)
Timber Stacking Sites	Electricity Powerlines	Hardwood Auction Site Plan (Eng)	
Timber Stacking Sites	Overhead powerline	Hardwood Auction Site Plan (Eng)	
Bridges	Underground powerline	Blocks	
Bridges		Blocks	

## Notes

Contract No: F55290

Grid Ref: SU 3134 0543

Site Name: Parkhill Nr Brockenhurst

### Access Information:

From Lyndhurst take A337 south and turn east on B3055. Continue on Tilery Rd (gravel) towards Standing Hat Car Park. Nearest postcode SO42 7QJ. Entrance W3W: //trumped.northward.ruin. Once through inclusion gate (standard FC key) follow stakes with pink tops towards //dragonfly.roadmap.winded for closest access to stock (left at crossroad).



**LOT 12**

**WOOD**

Island Thorns, Nr Fritham

**DESCRIPTION**

Hardwood logs at roadside by Volume

**AGENT RESPONSIBLE**

Jonathan Stocks  
Forestry England, Lyndhurst Office.  
South England Forest District.

Email:

Jonathan.stocks@forestryengland.uk

Tel: 07710748411

REF: F55291



Species	Number of logs	Estimated Quantity	Unit	Measurement procedure
OK	129	259.28	M3obf	Length and mid-diameter under bark
<b>Totals</b>	<b>129</b>	<b>259.28</b>		

**VIEWING ARRANGEMENTS**

By appointment during normal working hours. A log list will be available from the agent from 10/11/2023.

**SPECIAL CONDITIONS**

- 1. Contract period from 11/12/2023 to 28/06/2024
- 2. Contract Schedules and maps available from above address.

**PAYMENT**

One instalment due on 11/12/2023

Payment is required before uplift unless the Purchaser has sufficient credit with Forestry England. Forestry England may also charge a 10% deposit depending on the Purchaser's status. See the clauses in sections 13.13 to 13.15 of Forestry England's Standard Conditions for Forest Products.

**METHOD OF MARKING**

Timber Tags

**BIDDING**

Bids will be taken on a price per cubic metre over bark basis.



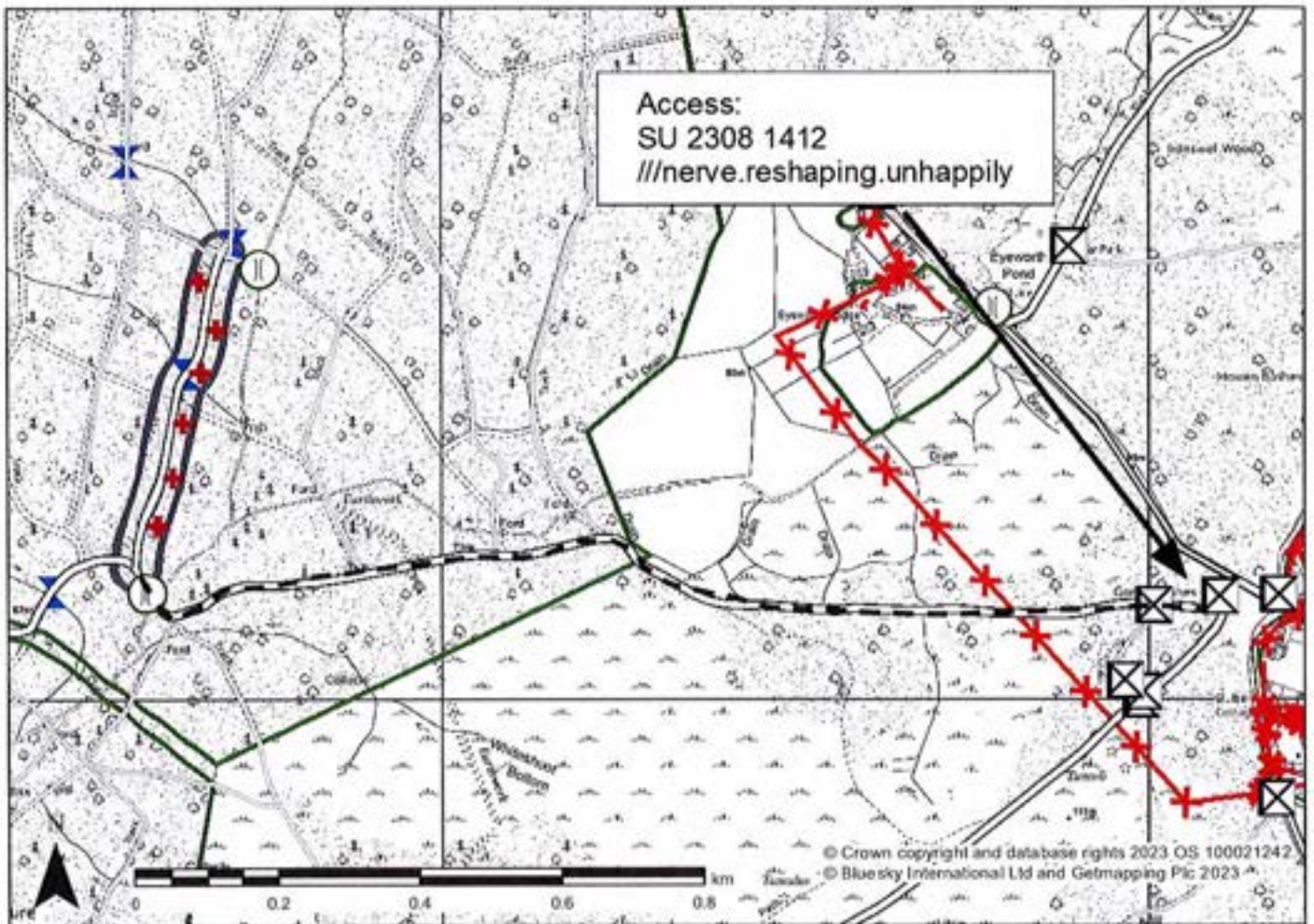

**Legend**

<b>Gates/Cattle Grids/Barriers</b>	<b>Forest Roads</b>	<b>Culverts</b>	<b>Minor Roads (GB)</b>
Gates/Cattle Grids/Barriers	Forest Roads	Culverts	Minor Roads (GB)
<b>Timber Stacking Sites</b>	<b>Rides</b>	<b>Hardwood Auction Site Plan (Eng.)</b>	
Timber Stacking Sites	Rides	Hardwood Auction Site Plan (Eng.)	
<b>Bridges</b>	<b>Electricity Powerlines</b>	<b>Blocks</b>	
Bridges	Overhead powerline	Blocks	
	Underground powerline		

## Notes

Contract No: F55291

Grid Ref: SU 2162 1440

Site Name: Island Thorns Nr Fritham

**Access Information:**  
 Access off M27 along B3079/B3078, continue west through Fritham past the Royal Oak and towards access at //nerve.reshaping.unhappily. Nearest postcode SO43 7HJ. Once through inclosure gate (standard FC key) move west towards //snooze.spray.leaky for closest access to stock (right at crossroad).

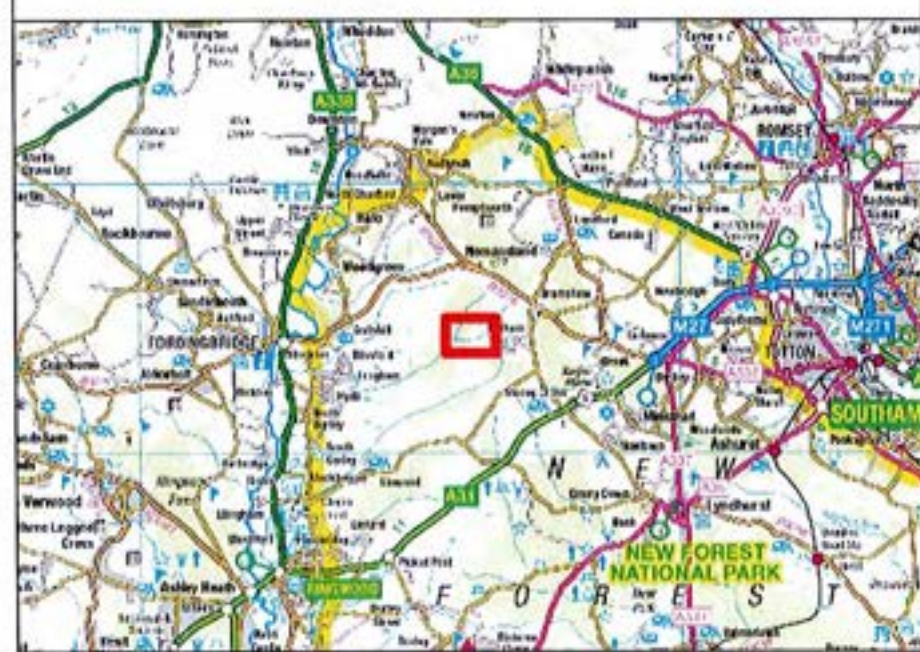

**LOT 13****WOOD**

Parkhill, Nr Brockenhurst

**DESCRIPTION**

Hardwood logs at roadside by Volume

**AGENT RESPONSIBLE**Jonathan Stocks  
Forestry England, Lyndhurst Office.  
South England Forest District.

Email:

Jonathan.stocks@forestryengland.uk

Tel: 07710748411

REF: F55316



Species	Number of logs	Estimated Quantity	Unit	Measurement procedure
OK	121	173	M3obf	Length and mid-diameter under bark
<b>Totals</b>	<b>121</b>	<b>173</b>		

**VIEWING ARRANGEMENTS**

By appointment during normal working hours. A log list will be available from the agent from 10/11/2023.

**SPECIAL CONDITIONS**

1. Contract period from 11/12/2023 to 28/06/2024
2. Contract Schedules and maps available from above address.

**PAYMENT**

One instalment due on 11/12/2023

Payment is required before uplift unless the Purchaser has sufficient credit with Forestry England. Forestry England may also charge a 10% deposit depending on the Purchaser's status. See the clauses in sections 13.13 to 13.15 of Forestry England's Standard Conditions for Forest Products.

**METHOD OF MARKING**

Timber Tags

**BIDDING**

Bids will be taken on a price per cubic metre over bark basis.

# Site Plan

Lot 13

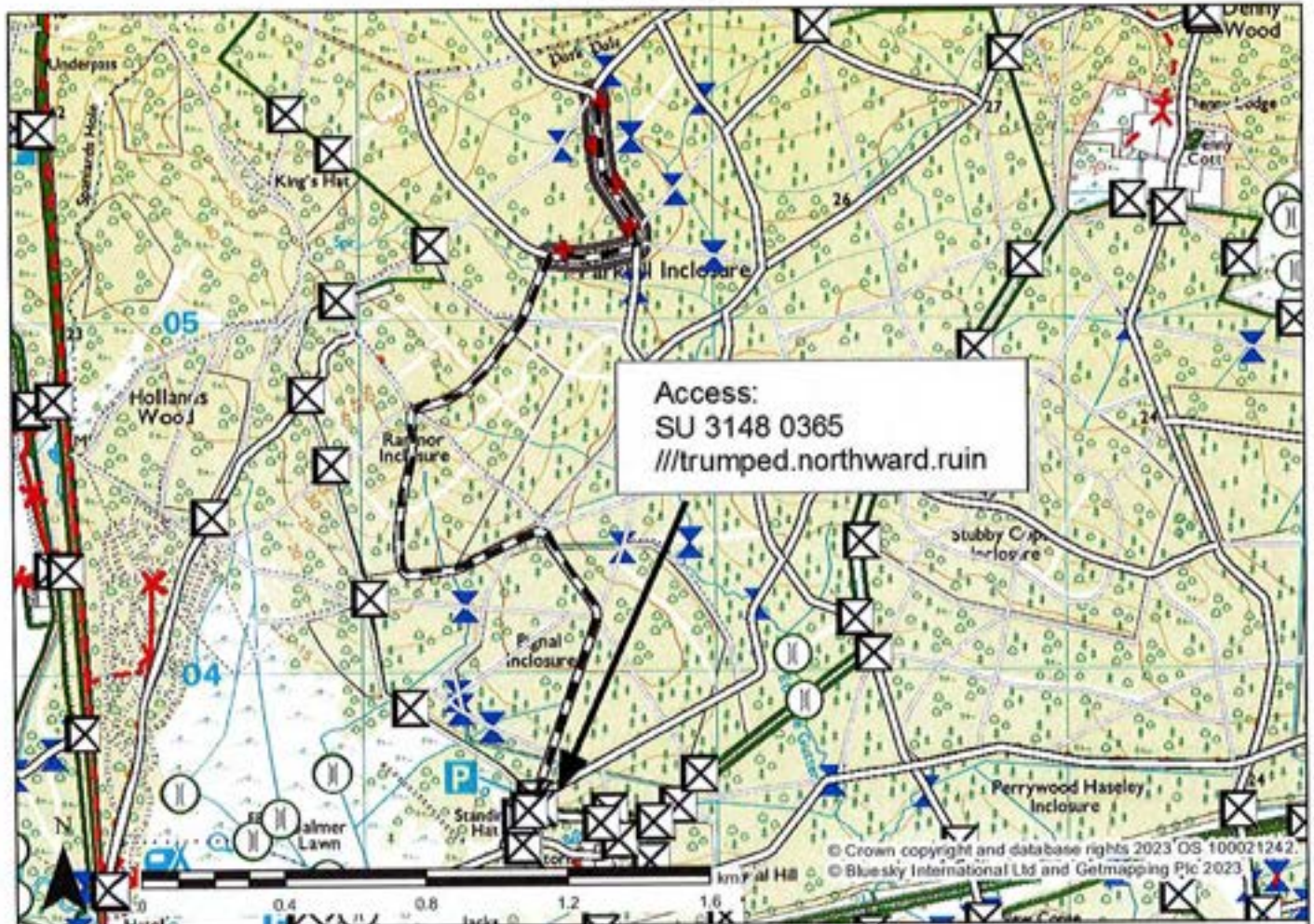

Access:  
SU 3148 0365  
//trumped.northward.ruin

Legend			
Gates/Cattle Grids/Barriers	Forest Roads	Culverts	Main Roads (GB)
Timber Stacking Sites	Rides	Hardwood Auction Site Plan (Eng.)	Main Roads (GB)
Bridges	Electricity Powerlines	Blocks	
	Overhead powerline		
	Underground powerline		

## Notes

Contract No: F55316

Grid Ref: SU 3166 0540

Site Name: Parkhill Nr Brockenhurst

### Access Information:

From Lyndhurst take A337 south and turn east on B3055. Continue on Tilery Rd (gravel) towards Standing Hat Car Park. Nearest postcode SO4 2 7QJ. Entrance W3W: //trumped.northward.ruin. Once through inclosure gate (standard FC key) follow stakes with pink tops towards //dragonfly.roadmap.winded for closest access to stock (right at crossroad).



**LOT 14****WOOD**

Spruce Ride, Forest of Dean

**DESCRIPTION**

Hardwood logs at roadside by volume

**AGENT RESPONSIBLE**

Simon McGrath

Forestry England, Coleford Office

West England Forest District

Email:

simon.mcgrath@forestryengland.uk

Tel: 07795 612842

**REF:** F55338

Species	Number of logs	Estimated Quantity	Unit	Measurement procedure
OK	24	42.08	M <sup>3</sup> obf	Length and mid-diameter over bark
<b>Totals</b>	<b>24</b>	<b>42.08</b>		

**VIEWING ARRANGEMENTS**

By appointment during normal working hours. A log list will be available from the agent on 16/10/23.

**SPECIAL CONDITIONS**

1. Contract period from 14/12/23 to 31/01/24
2. Contract Schedules and maps available from above address.
3. No chainsaw use without prior written permission from the contract manager.
4. All products detailed in the log list must be removed.

**PAYMENT**

One instalment due on 14/12/23.

Payment is required before uplift unless the Purchaser has sufficient credit with Forestry England. Forestry England may also charge a 10% deposit depending on the Purchaser's status. See the clauses in sections 13.13 to 13.15 of Forestry England's Standard Conditions for Forest Products.

**METHOD OF MARKING**

Timber tags

**BIDDING**

Bids will be taken on a price per cubic metre over bark basis.

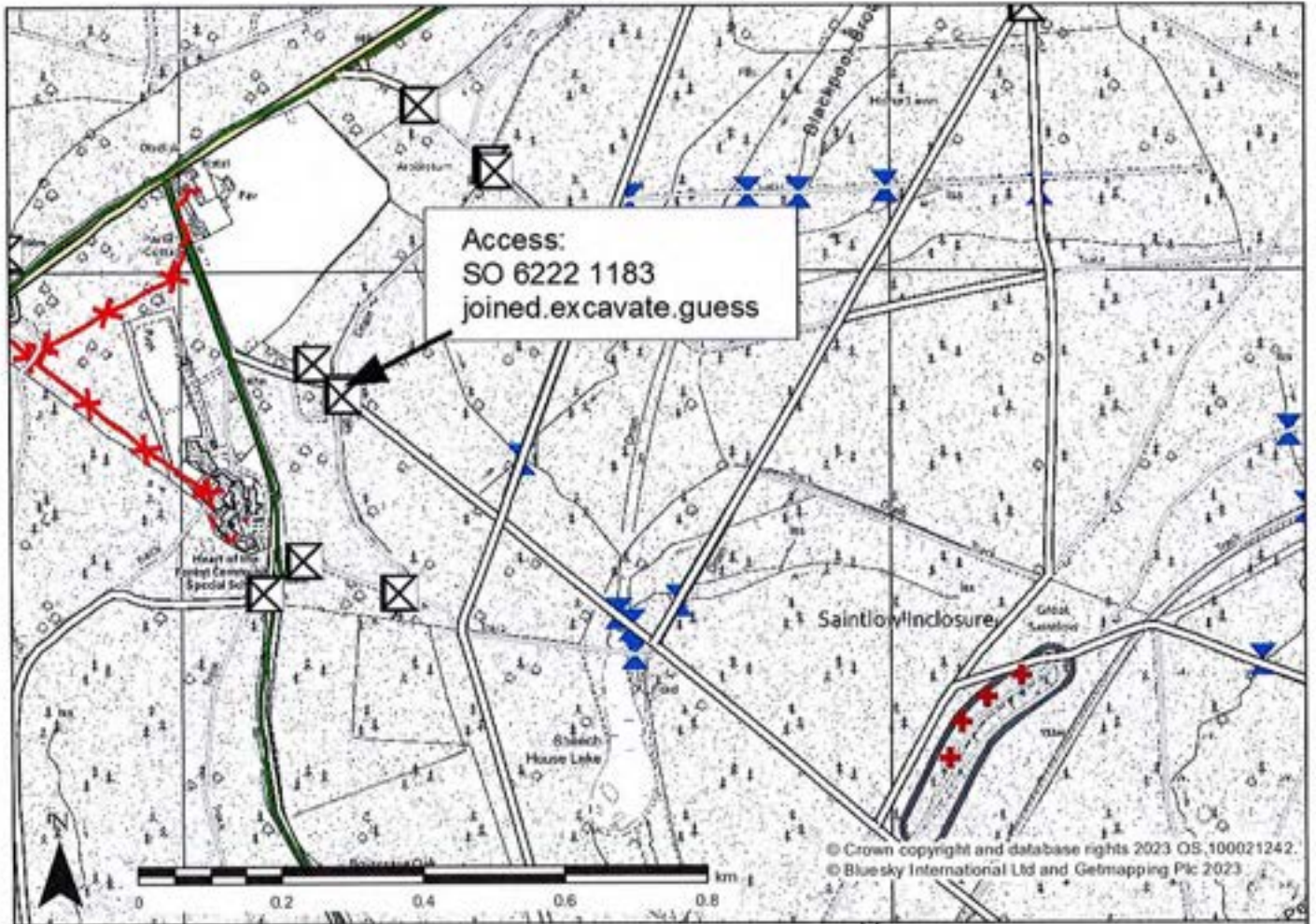

Legend	
<b>Gates/Cattle Grids/Barriers</b>	<b>Rides</b>
Gates/Cattle Grids/Barriers	Rides
<b>Timber Stacking Sites</b>	<b>Electricity Powerlines</b>
Timber Stacking Sites	Overhead powerline
<b>Forest Roads</b>	Underground powerline
Forest Roads	<b>Culverts</b>
	Culverts
<b>Hardwood Auction Site Plan (Eng)</b>	<b>Minor Roads (GB)</b>
Hardwood Auction Site Plan (Eng)	Minor Roads (GB)
<b>Blocks</b>	
Blocks	
<b>Secondary Roads (GB)</b>	
Secondary Roads (GB)	

## Notes

Contract No: F55338

Grid Ref: SO 6313 1132

Site Name: FoD Spruce Ride oak log

### Access Information:

Turn off B4226 at Speech House Hotel and head South for approximately 250 yards, turn left. Enter forest through 5 bar metal gate. Continue straight for approximately 1km, taking the fourth turning on the left. Logs are laid out on the left hand side of this area.



**LOT 15**

**WOOD**

Blaize Bailey, Forest of Dean

**DESCRIPTION**

Hardwood logs at roadside by volume

**AGENT RESPONSIBLE**

Simon McGrath  
Forestry England, Coleford Office  
West England Forest District  
Email:  
simon.mcgrath@forestryengland.uk  
Tel: 07795 612842



**REF:** F55339

Species	Number of logs	Estimated Quantity	Unit	Measurement procedure
OK	25	36.38	M <sup>3</sup> obf	Length and mid-diameter over bark
<b>Totals</b>	<b>25</b>	<b>36.38</b>		

**VIEWING ARRANGEMENTS**

By appointment during normal working hours. A log list will be available from the agent on 16/10/23.

**SPECIAL CONDITIONS**

1. Contract period from 14/12/23 to 31/01/24
2. Contract Schedules and maps available from above address.
3. No chainsaw use without prior written permission from the contract manager.
4. All products detailed in the log list must be removed.

**PAYMENT**

One instalment due on 14/12/23.

Payment is required before uplift unless the Purchaser has sufficient credit with Forestry England. Forestry England may also charge a 10% deposit depending on the Purchaser's status. See the clauses in sections 13.13 to 13.15 of Forestry England's Standard Conditions for Forest Products.

**METHOD OF MARKING**

Timber tags

**BIDDING**

Bids will be taken on a price per cubic metre over bark basis.

# Site Plan

Lot 15

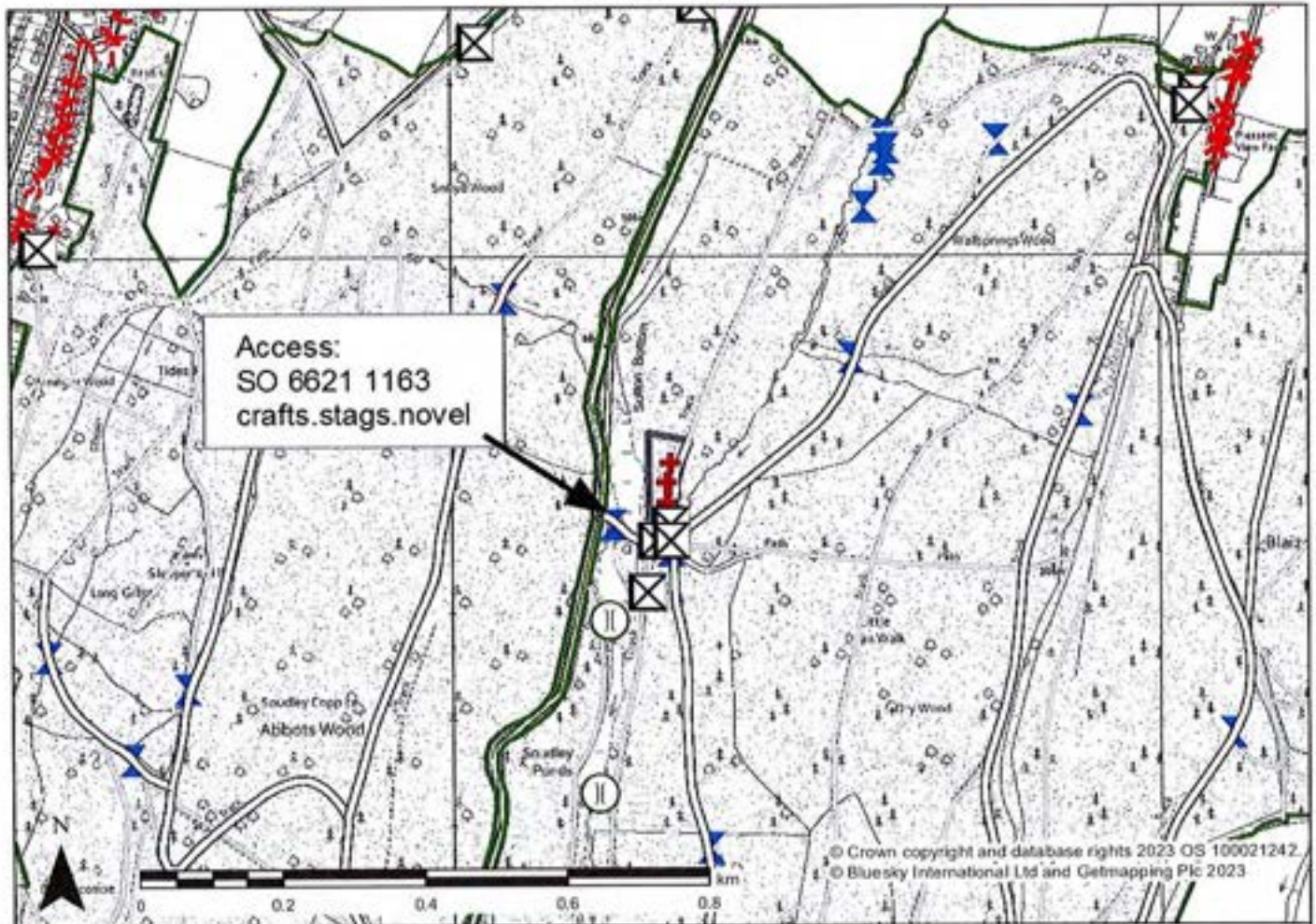

**Legend**

Gates/Cattle Grids/Barriers	Forest Roads	Culverts	Minor Roads (GB)
Gates/Cattle Grids/Barriers	Rides	Culverts	Minor Roads (GB)
Timber Stacking Sites	Hides	Hardwood Auction Site Plan (Eng.)	
Timber Stacking Sites	Electricity Powerlines	Hardwood Auction Site Plan (Eng.)	
Bridges	Overhead powerline	Blocks	
Bridges	Underground powerline	Blocks	

## Notes

Contract No: F55339

Grid Ref: SO 6630 1168

Site Name: FoD Blaize Bailey oak log 1

### Access Information:

Head North from Upper Soudley on Sutton Road. Turn right after 1.25km, signposted Soudley Ponds car park. Enter through the gate and turn left.



**LOT 16****WOOD**

Blaize Bailey, Forest of Dean

**DESCRIPTION**

Hardwood logs at roadside by volume

**AGENT RESPONSIBLE**

Simon McGrath

Forestry England, Coleford Office

West England Forest District

Email:

simon.mcgrath@forestryengland.uk

Tel: 07795 612842

**REF:** F55340

Species	Number of logs	Estimated Quantity	Unit	Measurement procedure
OK	25	32.87	M <sup>3</sup> obf	Length and mid-diameter over bark
<b>Totals</b>	<b>25</b>	<b>32.87</b>		

**VIEWING ARRANGEMENTS**

By appointment during normal working hours. A log list will be available from the agent on 16/10/23.

**SPECIAL CONDITIONS**

1. Contract period from 14/12/23 to 31/01/24
2. Contract Schedules and maps available from above address.
3. No chainsaw use without prior written permission from the contract manager.
4. All products detailed in the log list must be removed.

**PAYMENT**

One instalment due on 14/12/23.

Payment is required before uplift unless the Purchaser has sufficient credit with Forestry England. Forestry England may also charge a 10% deposit depending on the Purchaser's status. See the clauses in sections 13.13 to 13.15 of Forestry England's Standard Conditions for Forest Products.

**METHOD OF MARKING**

Timber tags

**BIDDING**

Bids will be taken on a price per cubic metre over bark basis.



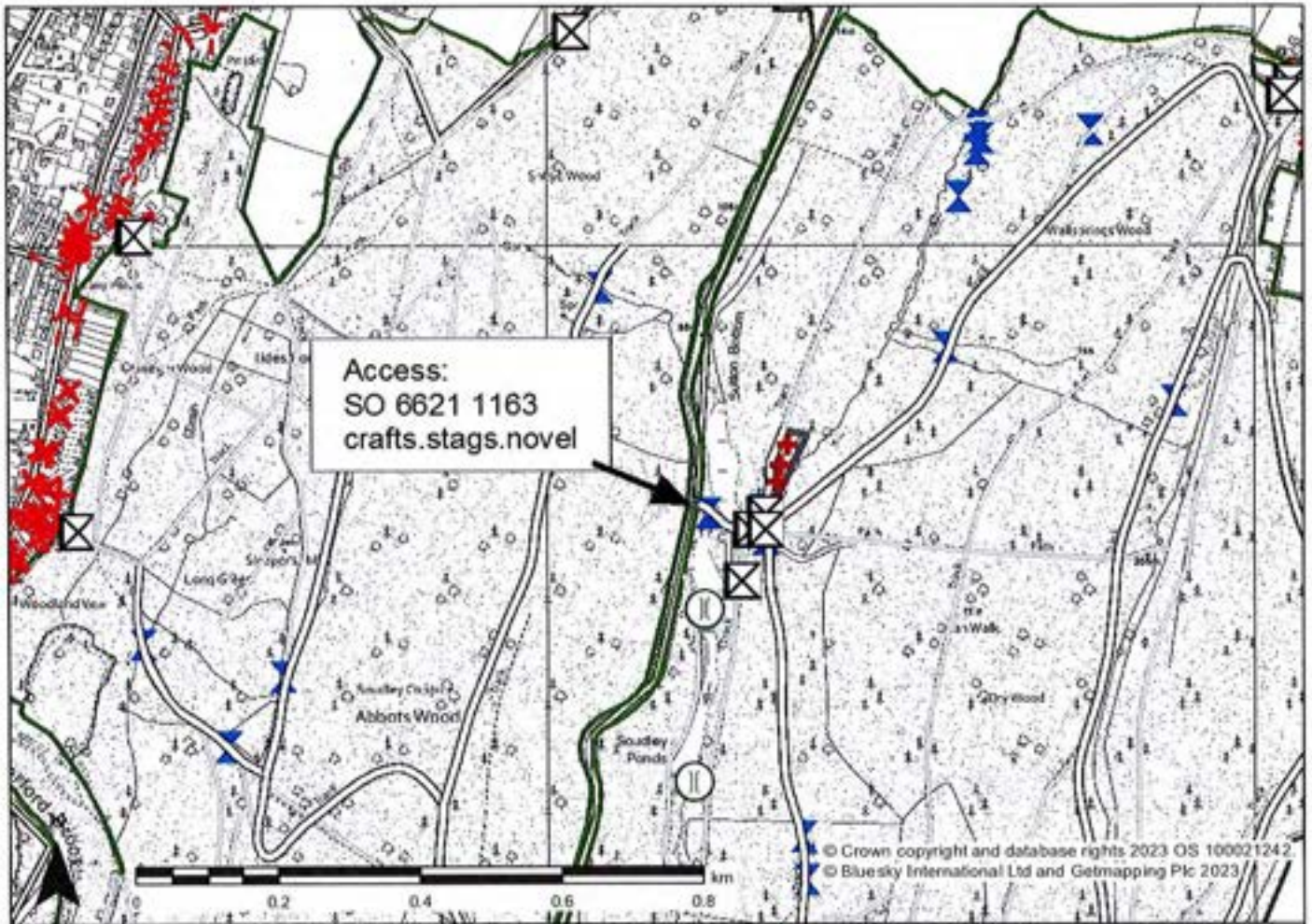

© Crown copyright and database rights 2023 OS 100021242  
© Bluesky International Ltd and Getmapping Plc 2023

**Legend**

Gates/Cattle Grids/Barriers	Forest Roads	Culverts	Minor Roads (GB)
Timber Stacking Sites	Rides	Hardwood Auction Site Plan (Eng.)	
Bridges	Electricity Powerlines	Blocks	
	Overhead powerline		
	Underground powerline		

## Notes

Contract No: F55340

Grid Ref: SO 6633 1168

Site Name: FoD Blaize Bailey oak log 2

**Access Information:**

Head North from Upper Soudley on Sutton Road. Turn right after 1.25km, signposted Soudley Ponds car park. Enter through the gate and turn left.



**LOT 17**

**WOOD**

Blaize Bailey, Forest of Dean

**DESCRIPTION**

Hardwood logs at roadside by volume

**AGENT RESPONSIBLE**

Simon McGrath  
Forestry England, Coleford Office  
West England Forest District  
Email:  
simon.mcgrath@forestryengland.uk  
Tel: 07795 612842

**REF:** F55341



Species	Number of logs	Estimated Quantity	Unit	Measurement procedure
OK	16	24.56	M <sup>3</sup> obf	Length and mid-diameter over bark
<b>Totals</b>	<b>16</b>	<b>24.56</b>		

**VIEWING ARRANGEMENTS**

By appointment during normal working hours. A log list will be available from the agent on 16/10/23.

**SPECIAL CONDITIONS**

1. Contract period from 14/12/23 to 31/01/24
2. Contract Schedules and maps available from above address.
3. No chainsaw use without prior written permission from the contract manager.
4. All products detailed in the log list must be removed.

**PAYMENT**

One payment due on 14/12/23.

Payment is required before uplift unless the Purchaser has sufficient credit with Forestry England. Forestry England may also charge a 10% deposit depending on the Purchaser's status. See the clauses in sections 13.13 to 13.15 of Forestry England's Standard Conditions for Forest Products.

**METHOD OF MARKING**

Timber tags

**BIDDING**

Bids will be taken on a price per cubic metre over bark basis.

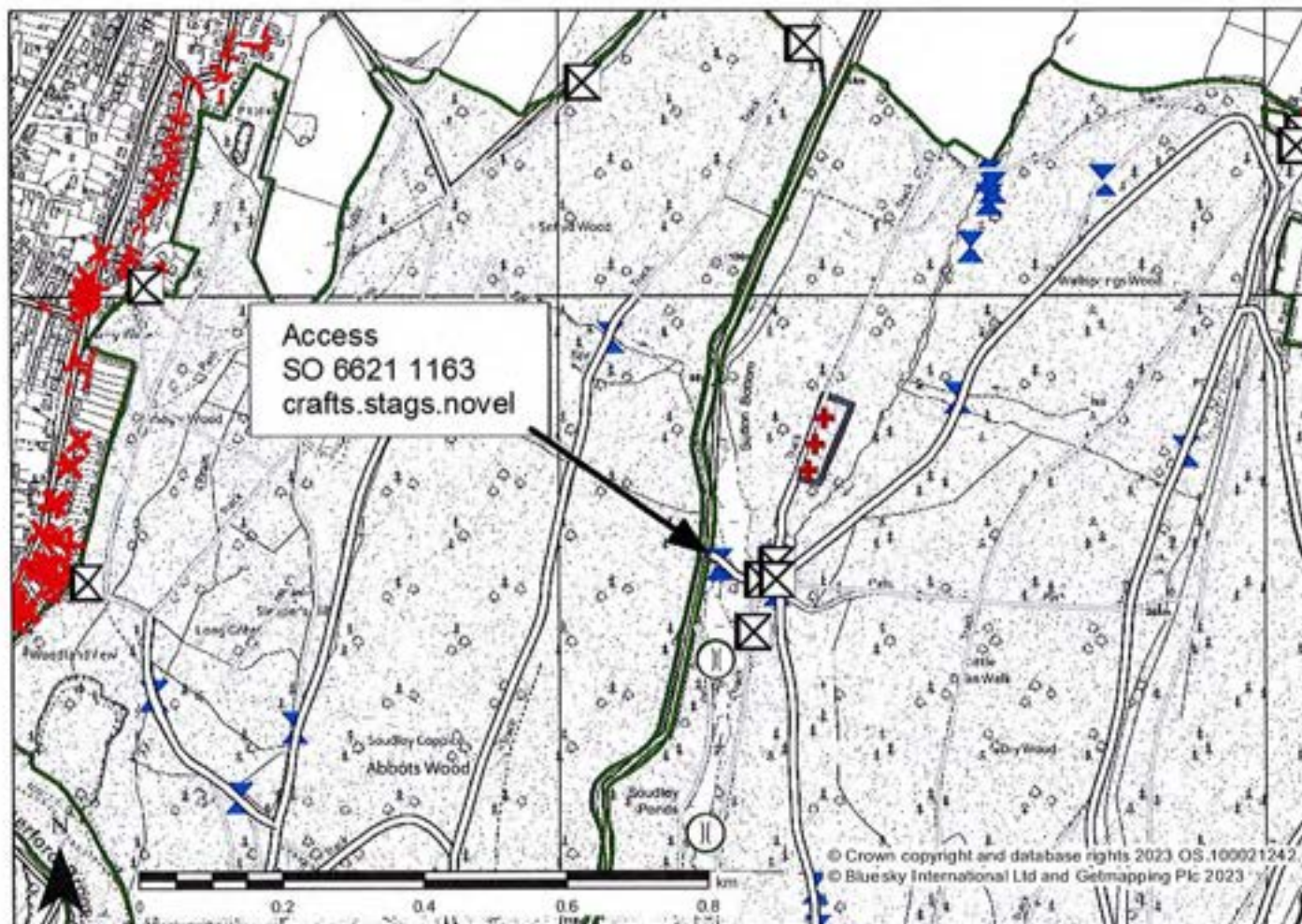

© Crown copyright and database rights 2023 OS 100021242  
© Bluesky International Ltd and Getmapping Plc 2023

**Legend**

Gates/Cattle Grids/Barriers	Forest Roads	Culverts	Minor Roads (OR)
Timber Stacking Sites	Rides	Hardwood Auction Site Plan (Eng.)	Minor Roads (OR)
Bridges	Electricity Powerlines	Blocks	
	Overhead powerline		
	Underground powerline		

## Notes

Contract No: F55341

Grid Ref: SO 6637 1179

Site Name: Fod Blaize Bailey oak log 3

**Access Information:**  
Head North from Upper Soudley on Sutton Road. Turn right after 1.25km, signposted Soudley Ponds car park. Enter through the gate and turn left.



**LOT 18****WOOD**

Blaize Bailey, Forest of Dean

**DESCRIPTION**

Hardwood logs at roadside by volume

**AGENT RESPONSIBLE**

Simon McGrath

Forestry England, Coleford Office

West England Forest District

Email:

simon.mcgrath@forestryengland.uk

Tel: 07795 612842

**REF:** F55342

Species	Number of logs	Estimated Quantity	Unit	Measurement procedure
OK	27	54.99	M <sup>3</sup> obf	Length and mid-diameter over bark
<b>Totals</b>	<b>27</b>	<b>54.99</b>		

**VIEWING ARRANGEMENTS**

By appointment during normal working hours. A log list will be available from the agent on 16/10/23.

**SPECIAL CONDITIONS**

1. Contract period from 14/12/23 to 31/01/24
2. Contract Schedules and maps available from above address.
3. No chainsaw use without prior written permission from the contract manager.
4. All products detailed in the log list must be removed.

**PAYMENT**

One payment due on 14/12/23.

Payment is required before uplift unless the Purchaser has sufficient credit with Forestry England. Forestry England may also charge a 10% deposit depending on the Purchaser's status. See the clauses in sections 13.13 to 13.15 of Forestry England's Standard Conditions for Forest Products.

**METHOD OF MARKING**

Timber tags

**BIDDING**

Bids will be taken on a price per cubic metre over bark basis.

# Site Plan

Lot 18

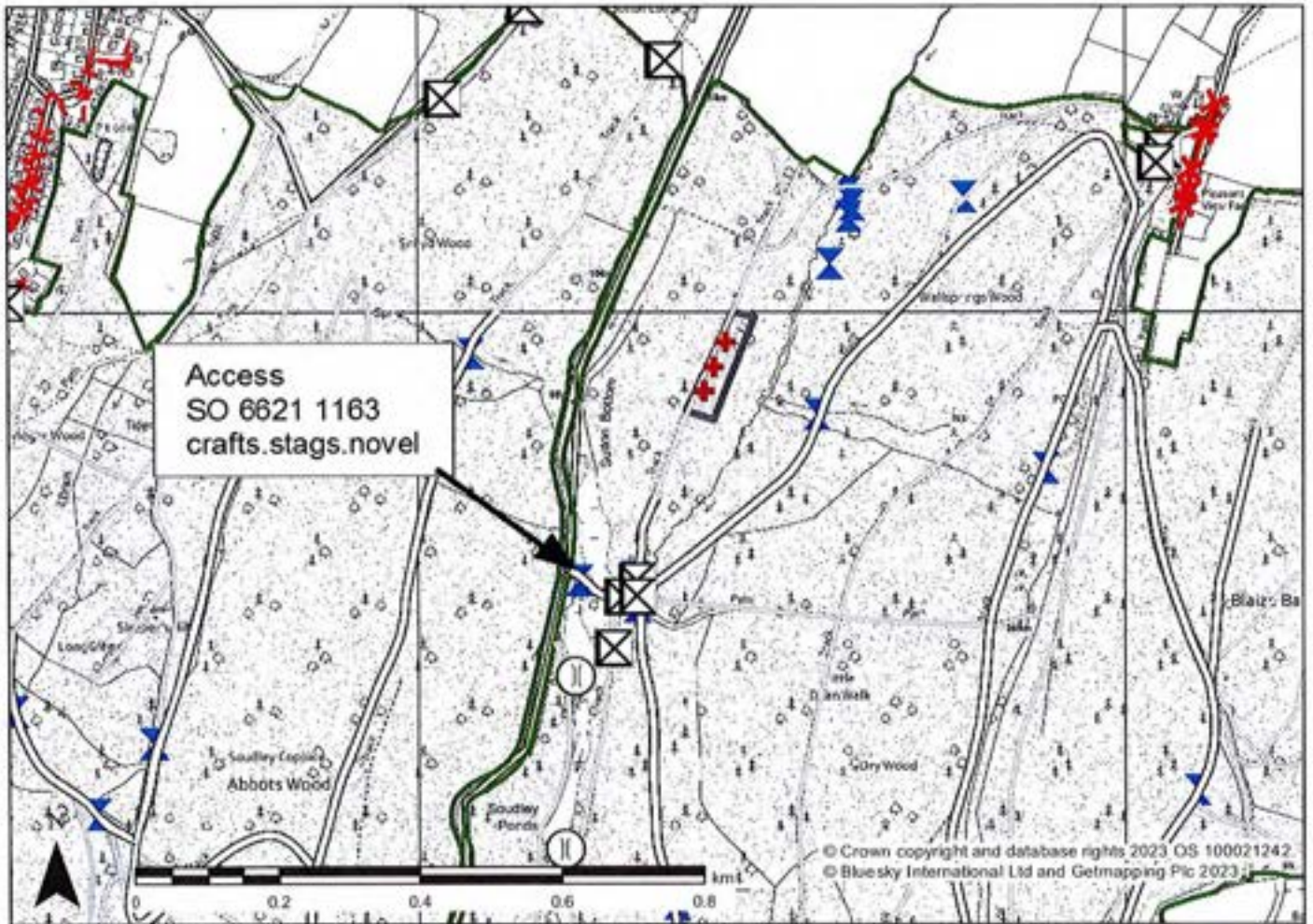

**Legend**

Gates/Cattle Grids/Barriers	Forest Roads	Culverts	Minor Roads (GR)
Timber Stacking Sites	Rides	Hardwood Auction Site Plan (Eng)	
Bridges	Electricity Powerlines	Blocks	
	Overhead powerline		
	Underground powerline		

## Notes

Contract No: F55342

Grid Ref: SO 6642 1192

Site Name: FoD Blaize Bailey oak log 4

**Access Information:**

Head North from Upper Soudley on Sutton Road. Turn right after 1.25km, signposted Soudley Ponds car park. Enter through the gate and turn left.



**LOT 19****WOOD**

Wendover Woods, Buckinghamshire

**DESCRIPTION**

Hardwood short roundwood at roadside by weight

**AGENT RESPONSIBLE**

Rob Bell  
 Chilterns Forest Office  
 Aston Clinton, Bucks  
 Email:  
 Robert.bell@forestryengland.uk  
 Tel: 07778025142

**REF:** F55337

Species	Number of logs	Estimated Quantity	Unit	Measurement procedure
Ash	-	500	tonnes	Via weighbridge
<b>Totals</b>	-	<b>500</b>		

**VIEWING ARRANGEMENTS**

By appointment during normal working hours.

**SPECIAL CONDITIONS**

1. Contract period from 01/12/23 to 31/01/24
2. Contract Schedules and maps available from above address.

**PAYMENT**

Payment required within 30 days of invoice. The Forestry Commission may also charge a 10% deposit depending on the Purchaser's status.

**METHOD OF MARKING**

Paint

**BIDDING**

Bids will be taken on a price per tonne basis.

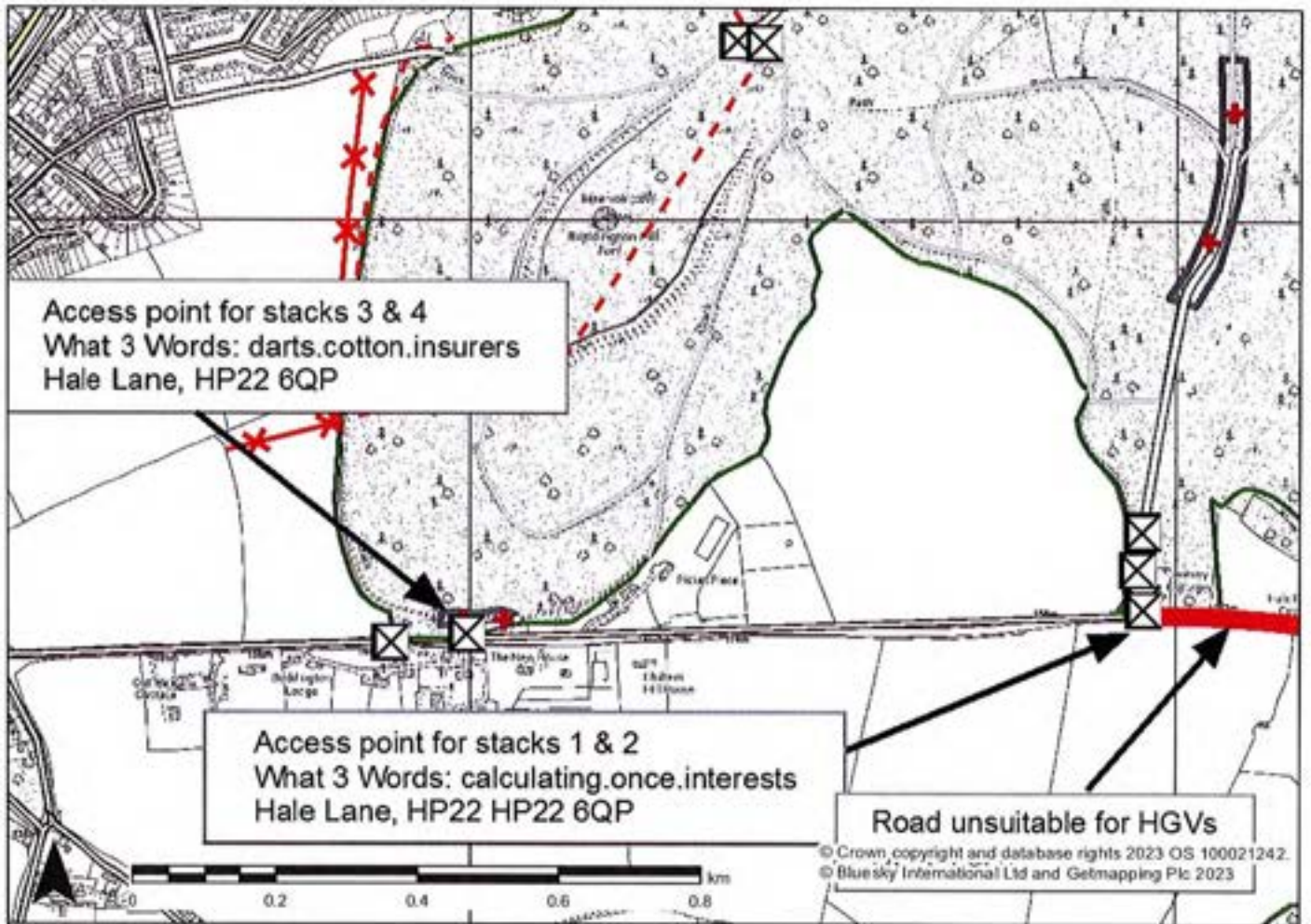

**Legend**

<b>Gates/Catch Grids/Barriers</b>	<b>Rides</b>	<b>Hardwood Auction Site Plan (Eng.)</b>	<b>Secondary Roads (GB)</b>
⊗ Sites/Catch Grids/Barriers	— Rides	□ Hardwood Auction Site Plan (Eng.)	== Secondary Roads (GB)
<b>Timber Stacking Sites</b>	<b>Electricity Powerlines</b>	<b>Blocks</b>	— Minor Roads (GB)
+ Timber Stacking Sites	← Overhead powerline	□ Blocks	== Minor Roads (GB)
<b>Forest Roads</b>	- Underground powerline		
== Forest Roads			

## Notes

Contract No: F55337

Grid Ref: SP 8885 0776

Site Name: Wendover Woods & Hale Wood

**Access Information:**  
Access to Wendover Woods is via Hale lane, coming from Wendover town. Access to Hale Wood must be via Taylors Lane, coming from St Leonards village. The section of Hale Lane between Wendover Woods and Hale Lane is not suitable for HGVs or other large vehicles.



# Site Plan

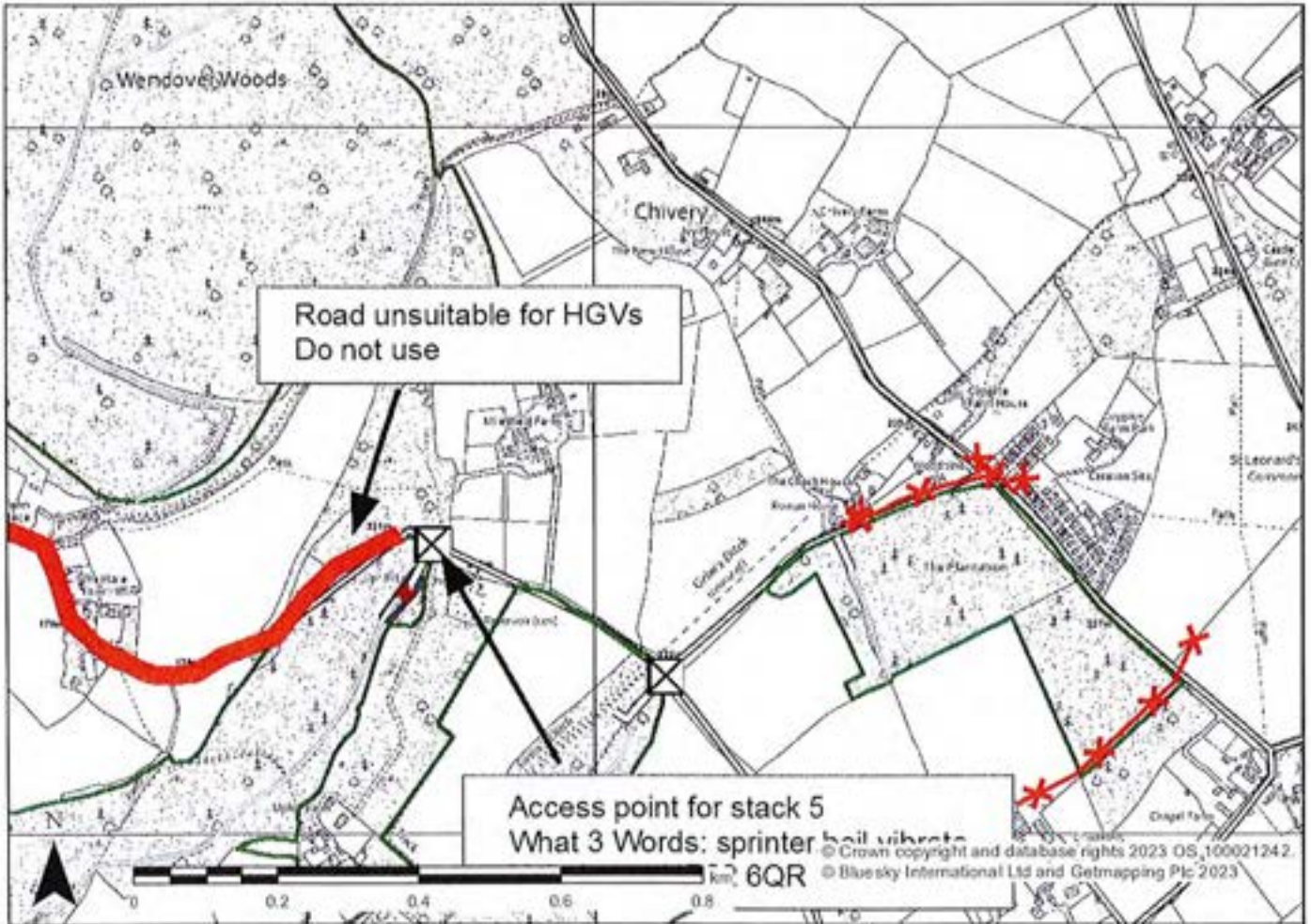

Legend

Gate/Cattle Grid/Barriers	Forest Roads	Electricity Powerlines	Hardwood Auction Site Plan (Ring)
Timber Stacking Sites	Rides	Overhead powerline	Hardwood Auction Site Plan (Ring)
		Underground powerline	Blocks

## Notes

Contract No: F55337

Grid Ref: SP 8885 0776

Site Name: Wendover Woods & Hale Wood

### Access Information:

Access to Wendover Woods is via Hale lane, coming from Wendover town. Access to Hale Wood must be via Taylors Lane, coming from St Leonards village. The section of Hale Lane between Wendover Woods and Hale Lane is not suitable for HGVs or other large vehicles.







**LOT 20****WOOD**

Ringwood, Nr Verwood

**DESCRIPTION**

Hardwood short roundwood at roadside by weight

**AGENT RESPONSIBLE**Jonathan Stocks  
Forestry England, Lyndhurst Office.  
South England Forest District.

Email:

Jonathan.stocks@forestryengland.uk

Tel: 07710748411

REF: F55288



Species	Number of stacks	Estimated total Quantity	Unit	Measurement procedure
80% Beech 20% Ash	2	150	tonnes	Via weighbridge.
<b>Totals</b>	<b>2</b>	<b>150</b>		

**VIEWING ARRANGEMENTS**

By appointment during normal working hours.

**SPECIAL CONDITIONS**

1. Contract period from 11/12/2023 to 28/06/2024
2. Contract Schedules and maps available from above address.

**PAYMENT**

Payment required within 30 days of invoice. The Forestry Commission may also charge a 10% deposit depending on the Purchaser's status.

**METHOD OF MARKING**

Stack measurement as per Forest Mensuration Handbook section 5.5.1. (conversion factor using Method 2). All stacks will be marked with the Contract Ref No. F55288.

**BIDDING**

Bids will be taken on a price per tonne basis.

# Site Plan

Lot 20

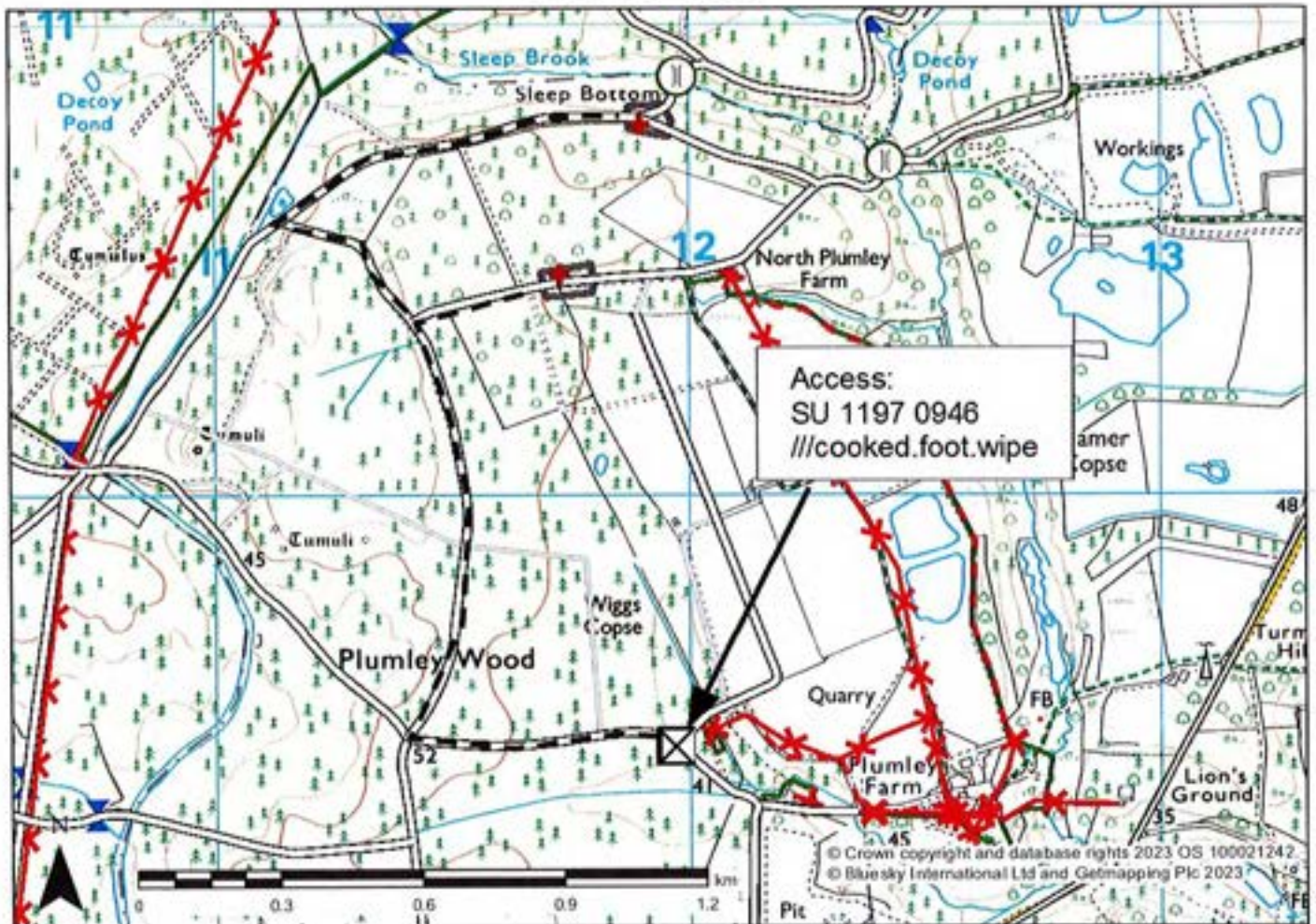

**Legend**

	<b>Gates/Cattle Grids/Barriers</b>		<b>Forest Roads</b>		<b>Culverts</b>		<b>Minor Roads (GB)</b>
	Gates/Cattle Grids/Barriers		Forest Roads		Culverts		Minor Roads (GB)
	<b>Timber Stacking Sites</b>		<b>Rides</b>		<b>Hardwood Auction Site Plan (Eng.)</b>		
	Timber Stacking Sites		Rides		Hardwood Auction Site Plan (Eng.)		
	<b>Bridges</b>		<b>Electricity Powerlines</b>		<b>Blocks</b>		
	Bridges		Overhead powerline		Blocks		
			Underground powerline				

## Notes

Contract No: F55288

Grid Ref: SU 1182 1062

Site Name: Ringwood Nr Verwood

### Access Information:

Access off A31 along B3081 turning right on to Alderholt Rd towards turn off to gravel road at //happen.army.highlighted. Continue north towards forest gate access (standard FC key) at //cooked.foot.wipe. Nearest postcode BH24 3QB.



**LOT 21****WOOD**

Lynford, Snakewood, Nr Mundford

**DESCRIPTION**

Conifer Logs at roadside by volume

**AGENT RESPONSIBLE**

Andrew Whistler

FE Santon Downham

East England Forest District

Email:

Andrew.whistler@forestryengland.uk

Tel: 07785953564

**REF:** F55334

Species	Number of logs	Estimated Quantity	Unit	Measurement procedure
Douglas Fir	26	141.94	M <sup>3</sup> obf	Length and mid-diameter under bark
<b>Totals</b>	<b>26</b>	<b>141.94</b>		

**VIEWING ARRANGEMENTS**

By appointment during normal working hours. A log list will be available from the agent from 14/10/23.

**SPECIAL CONDITIONS**

1. Contract period from 11/12/23 to 29/02/24
2. Contract Schedules and maps available from above address.

**PAYMENT**

One instalment due on 11/12/23.

Payment is required before uplift unless the Purchaser has sufficient credit with Forestry England. Forestry England may also charge a 10% deposit depending on the Purchaser's status. See the clauses in sections 13.13 to 13.15 of Forestry England's Standard Conditions for Forest Products.

**METHOD OF MARKING**

Timber tags

Timber length and mid diameter overbark

**BIDDING**

Bids will be taken on a price per cubic metre over bark basis.

# Site Plan

Lot 21

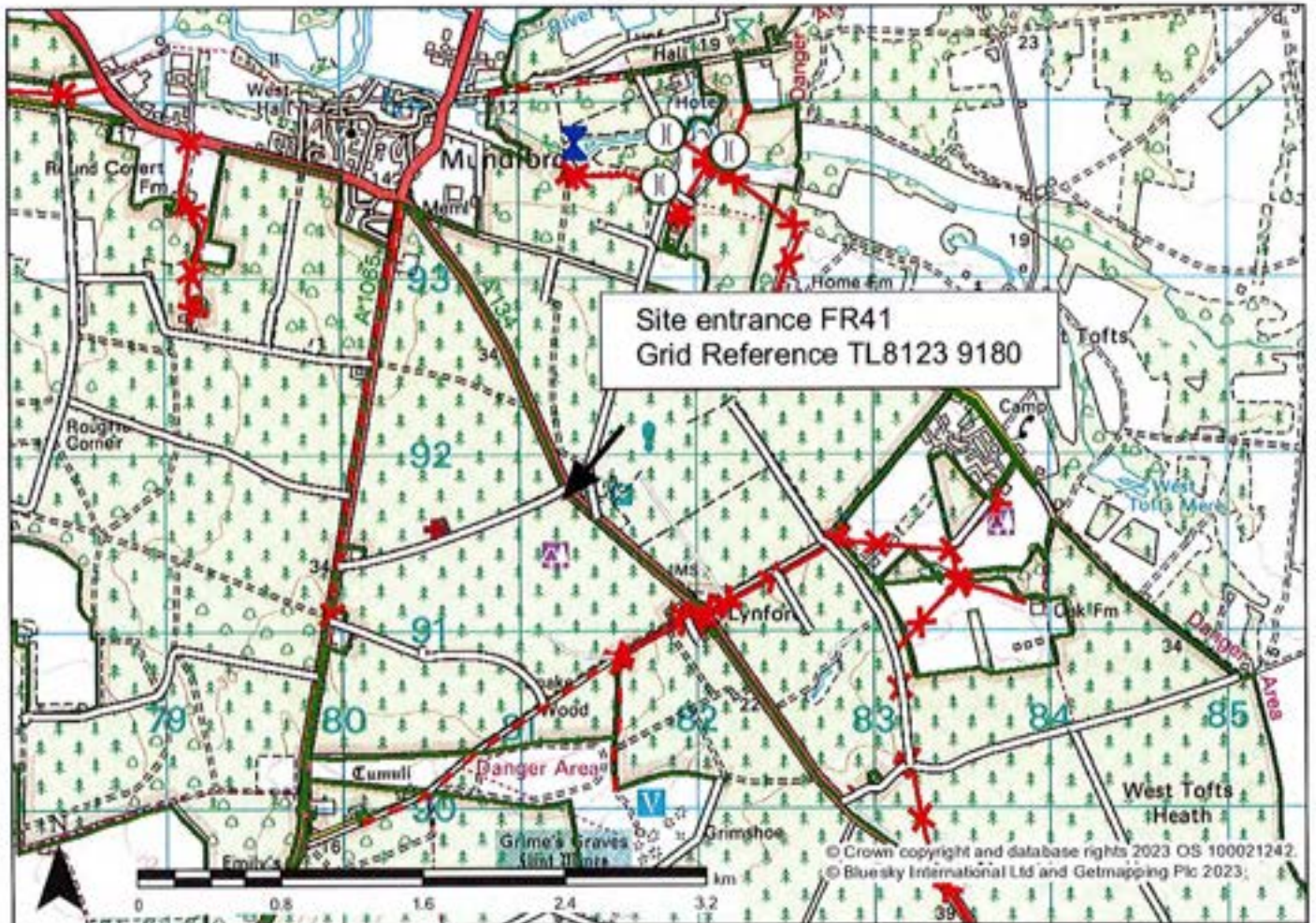

Site entrance FR41  
Grid Reference TL8123 9180

Legend	
<b>Timber Stacking Sites</b>	<b>Rides</b>
Timber Stacking Sites	Rides
<b>Bridges</b>	<b>Electricity Powerlines</b>
Bridges	Overhead powerline
<b>Forest Roads</b>	Underground powerline
Forest Roads	<b>Culverts</b>
	Culverts
<b>Hardwood Auction Site Plan (Eng.)</b>	<b>Minor Roads (GB)</b>
Hardwood Auction Site Plan (Eng.)	Minor Roads (GB)
<b>Blocks</b>	
Blocks	
<b>Main Roads (GB)</b>	
Main Roads (GB)	

## Notes

Contract No: F55334  
  
Grid Ref: TL 8057 9158  
  
Site Name: Snakewood Douglas fir

### Access Information:

Heading along the A134 from Thetford towards Mundford. 8.5km from Thetford on the lefthand side is Fire route 41. Travel 0.7km along the fire route and the Douglas fir will be on your righthand side. Access along fire route 41 is through a padlocked gate.



**LOT 22****WOOD**

West Tofts, Nr Mundford

**DESCRIPTION**

Conifer Logs at roadside by volume

**AGENT RESPONSIBLE**

Andrew Whistler

FE Santon Downham

East England Forest District

Email:

Andrew.whistler@forestryengland.uk

Tel: 07785953564

**REF:** F55335

Species	Number of logs	Estimated Quantity	Unit	Measurement procedure
European Larch	78	131.47	M <sup>3</sup> obf	Length and mid-diameter under bark
<b>Totals</b>	<b>78</b>	<b>131.47</b>		

**VIEWING ARRANGEMENTS**

By appointment during normal working hours. A log list will be available from the agent from 14/10/23.

**SPECIAL CONDITIONS**

1. Contract period from 11/12/23 to 29/02/24
2. Contract Schedules and maps available from above address.

**PAYMENT**

One instalment due on 11/12/23.

Payment is required before uplift unless the Purchaser has sufficient credit with Forestry England. Forestry England may also charge a 10% deposit depending on the Purchaser's status. See the clauses in sections 13.13 to 13.15 of Forestry England's Standard Conditions for Forest Products.

**METHOD OF MARKING**

Timber tags

Timber length and mid diameter overbark

**BIDDING**

Bids will be taken on a price per cubic metre over bark basis.

# Site Plan

Lot 22

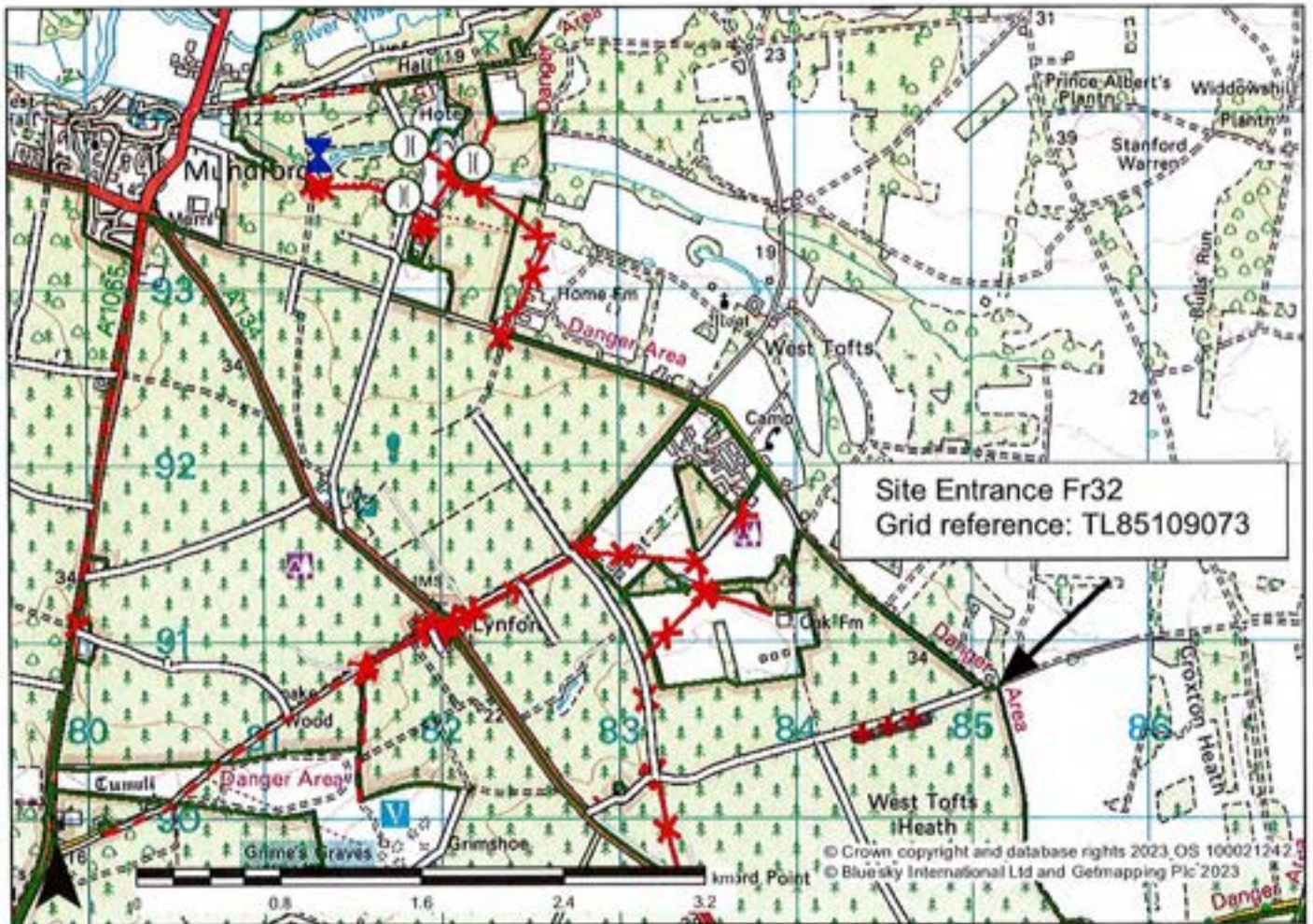

**Legend**

<b>Timber Stacking Sites</b>	<b>Rides</b>	<b>Hardwood Auction Site Plan (Eng.)</b>	<b>Minor Roads (GB)</b>
Timber Stacking Sites	Rides	Hardwood Auction Site Plan (Eng.)	Minor Roads (GB)
<b>Bridges</b>	<b>Electricity Powerlines</b>	<b>Blocks</b>	
Bridges	Overhead powerline	Blocks	
<b>Forest Roads</b>	Underground powerline	<b>Main Roads (GB)</b>	
Forest Roads	<b>Culverts</b>	Main Roads (GB)	
	Culverts		

## Notes

Contract No:

Grid Ref: TL 8453 9052

Site Name: West Tofts European Larch

**Access information:**

Heading along the A134 from Thetford towards Mundford, 7.8km from Thetford on the righthand side there's a turning towards West Tofts camp. Go along this road for 1.1km. Turn Right go a further 2.4km and Fire route 32 will appear on the righthand side. Travel 0.2km along the fire route and the European larch will appear on the lefthand side. Access to the material will be through a Padlocked gate.



**LOT 23**

**WOOD**

Ringwood, Nr Verwood

**DESCRIPTION**

Conifer logs at roadside by volume

**AGENT RESPONSIBLE**

Jonathan Stocks  
Forestry England, Lyndhurst Office.  
South England Forest District.

Email:

Jonathan.stocks@forestryengland.uk

Tel: 07710748411

REF: F55289



Species	Number of logs	Estimated Quantity	Unit	Measurement procedure
Douglas Fir	13	46.21	M <sup>3</sup> obf	Length and mid-diameter under bark
<b>Totals</b>	<b>13</b>	<b>46.21</b>		

**VIEWING ARRANGEMENTS**

By appointment during normal working hours. A log list will be available from the agent from 27/10/2023.

**SPECIAL CONDITIONS**

1. Contract period from 11/12/2023 to 28/06/2024
2. Contract Schedules and maps available from above address.

**PAYMENT**

One instalment due on 11/12/2023

Payment is required before uplift unless the Purchaser has sufficient credit with Forestry England. Forestry England may also charge a 10% deposit depending on the Purchaser's status. See the clauses in sections 13.13 to 13.15 of Forestry England's Standard Conditions for Forest Products.

**METHOD OF MARKING**

Timber Tags

**BIDDING**

Bids will be taken on a price per cubic metre over bark basis.



# Site Plan

Lot 23

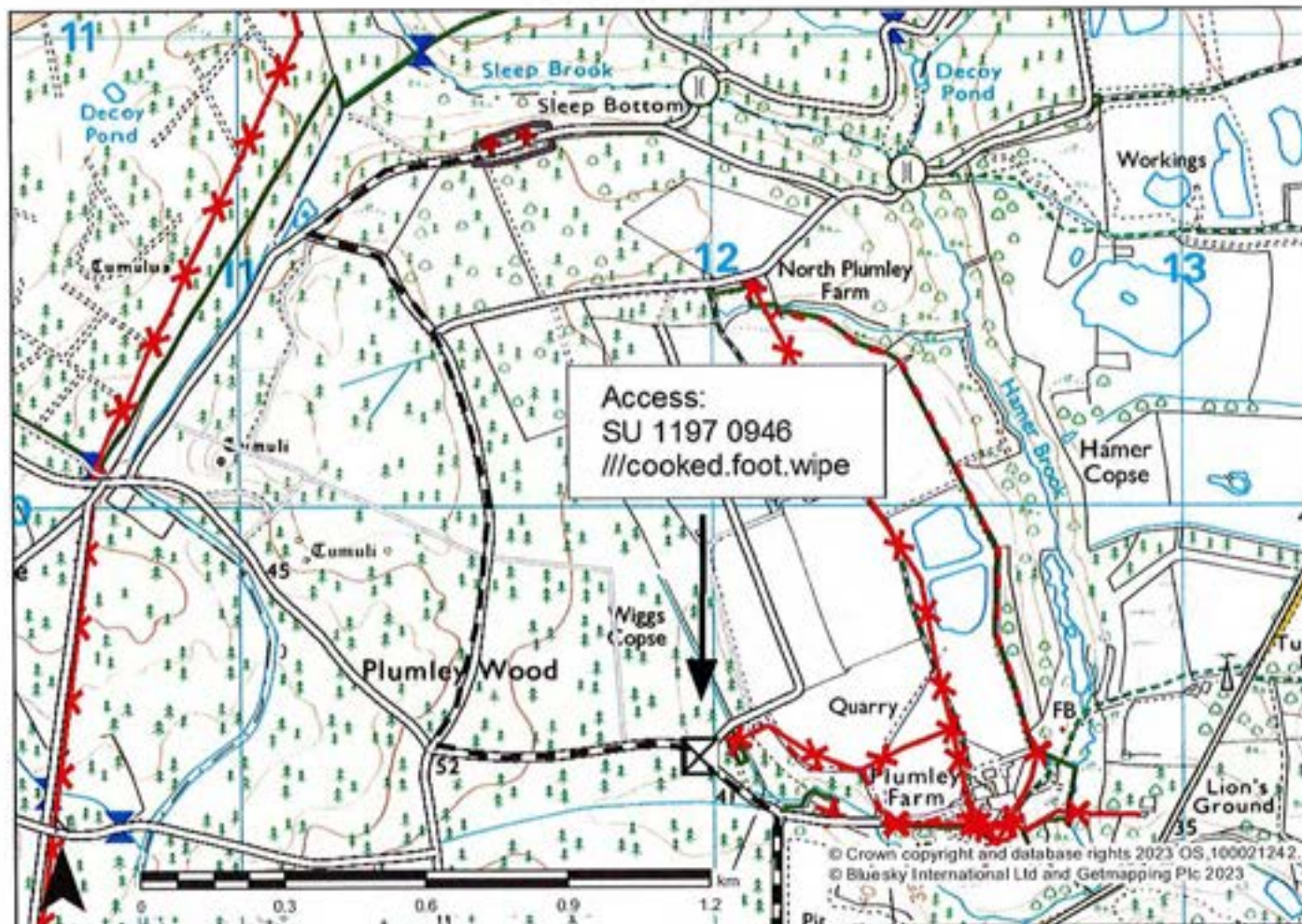

© Crown copyright and database rights 2023 OS, 100021242.  
© Bluesky International Ltd and Getmapping Plc 2023

**Legend**

Gates/Cattle Grids/Barriers	Forest Roads	Culverts	Minor Roads (GB)
Timber Stacking Sites	Rides	Hardwood Auction Site Plan (Eng.)	Minor Roads (GB)
Bridges	Electricity Powerlines	Blocks	
	Overhead powerline		
	Underground powerline		

## Notes

Contract No: F55289

Grid Ref: SU 1158 1077

Site Name: Ringwood Nr Verwood

**Access Information:**  
Access off A31 along B3081 turning right on to Alderholt Rd towards turn off to gravel road at //happen.army.highlighted. Continue north towards forest gate access (standard FC key) at //cooked.foot.wipe. Nearest postcode BH24 3QB.



**LOT 24****WOOD**

Blaize Bailey, Forest of Dean

**DESCRIPTION**

Conifer logs at roadside by volume

**AGENT RESPONSIBLE**

Simon McGrath

Forestry England, Coleford Office

West England Forest District

Email:

simon.mcgrath@forestryengland.uk

Tel: 07795 612842

**REF:** F55343

Species	Number of logs	Estimated Quantity	Unit	Measurement procedure
Coast Redwood	16	51.98	M <sup>3</sup> obf	Length and mid-diameter over bark
<b>Totals</b>	<b>16</b>	<b>51.98</b>		

**VIEWING ARRANGEMENTS**

By appointment during normal working hours. A log list will be available from the agent on 16/10/23.

**SPECIAL CONDITIONS**

1. Contract period from 14/12/23 to 31/01/24
2. Contract Schedules and maps available from above address.
3. No chainsaw use without prior written permission from the contract manager.
4. All products detailed in the log list must be removed.

**PAYMENT**

One instalment due on 14/12/23.

Payment is required before uplift unless the Purchaser has sufficient credit with Forestry England. Forestry England may also charge a 10% deposit depending on the Purchaser's status. See the clauses in sections 13.13 to 13.15 of Forestry England's Standard Conditions for Forest Products.

**METHOD OF MARKING**

Timber tags

**BIDDING**

Bids will be taken on a price per cubic metre over bark basis.

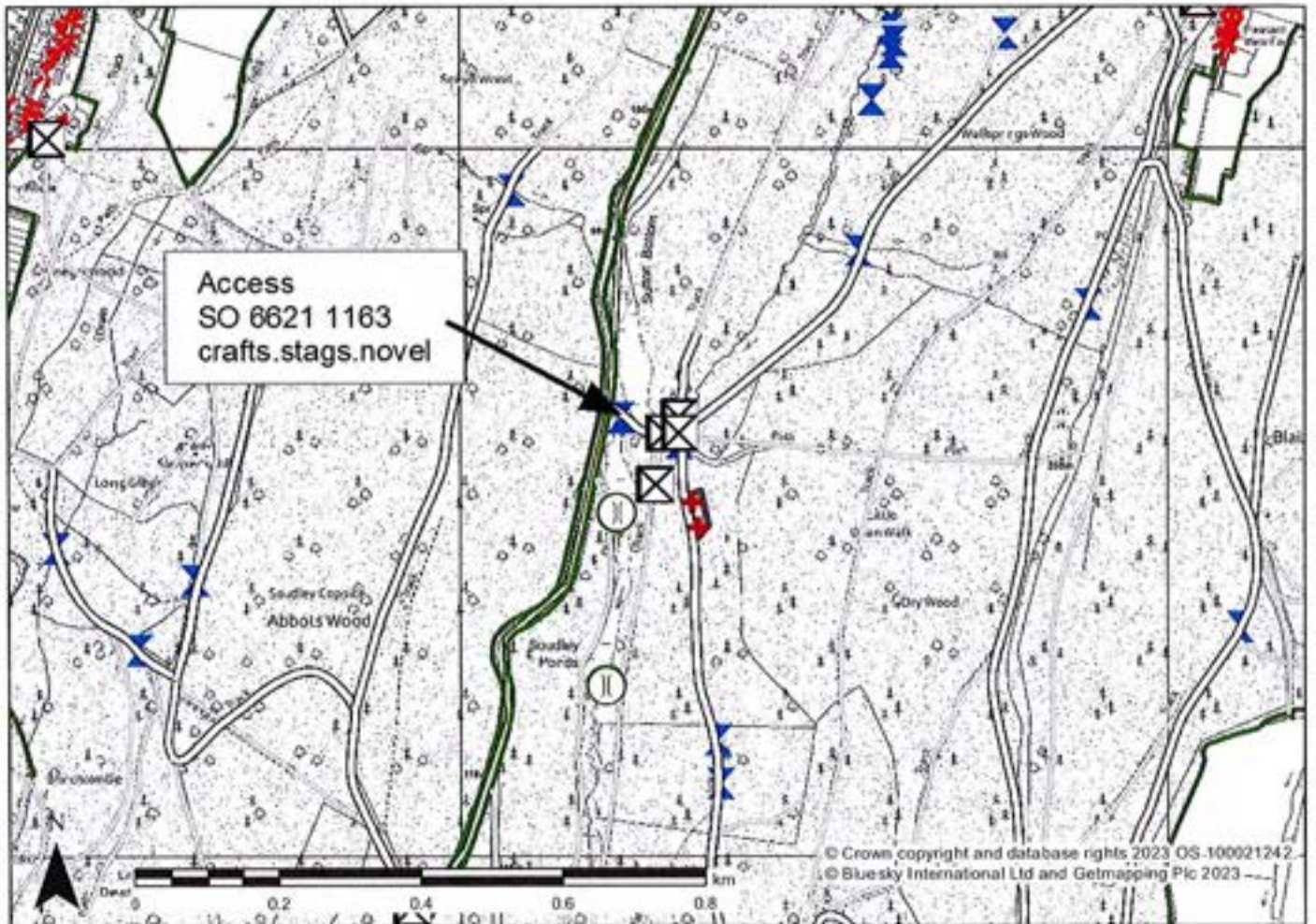

### Legend

Gates/Cattle Grids/Barriers	Forest Roads	Culverts	Minor Roads (GB)
Gates/Cattle Grids/Barriers	Rides	Culverts	Minor Roads (GB)
Timber Stacking Sites	Rides	Hardwood Auction Site Plan (Eng.)	
Timber Stacking Sites	Electricity Powerlines	Blocks	
Bridges	Overhead powerline	Blocks	
Bridges	Underground powerline		

## Notes

Contract No: F55343

Grid Ref: SO 6633 1148

Site Name: FoD Blaize Bailey coast  
redwood log

### Access Information:

Head North from Upper Soudley on Sutton Road. Turn right after 1.25km, signposted Soudley Ponds car park. Enter through the gate and turn left.



**LOT 25**

**WOOD**

Blaize Bailey, Forest of Dean

**DESCRIPTION**

Conifer logs at roadside by volume

**AGENT RESPONSIBLE**

Simon McGrath  
Forestry England, Coleford Office  
West England Forest District  
Email:  
simon.mcgrath@forestryengland.uk  
Tel: 07795 612842

**REF:** F55344



Species	Number of logs	Estimated Quantity	Unit	Measurement procedure
European Larch	63	150.21	M <sup>3</sup> obf	Length and mid-diameter over bark
<b>Totals</b>	<b>63</b>	<b>150.21</b>		

**VIEWING ARRANGEMENTS**

By appointment during normal working hours. A log list will be available from the agent on 16/10/23.

**SPECIAL CONDITIONS**

1. Contract period from 14/12/23 to 31/01/24
2. Contract Schedules and maps available from above address.
3. No chainsaw use without prior written permission from the contract manager.
4. All products detailed in the log list must be removed.

**PAYMENT**

One instalment due on 14/12/23.

Payment is required before uplift unless the Purchaser has sufficient credit with Forestry England. Forestry England may also charge a 10% deposit depending on the Purchaser's status. See the clauses in sections 13.13 to 13.15 of Forestry England's Standard Conditions for Forest Products.

**METHOD OF MARKING**

Timber tags

**BIDDING**

Bids will be taken on a price per cubic metre over bark basis.

# Site Plan

Lot 25

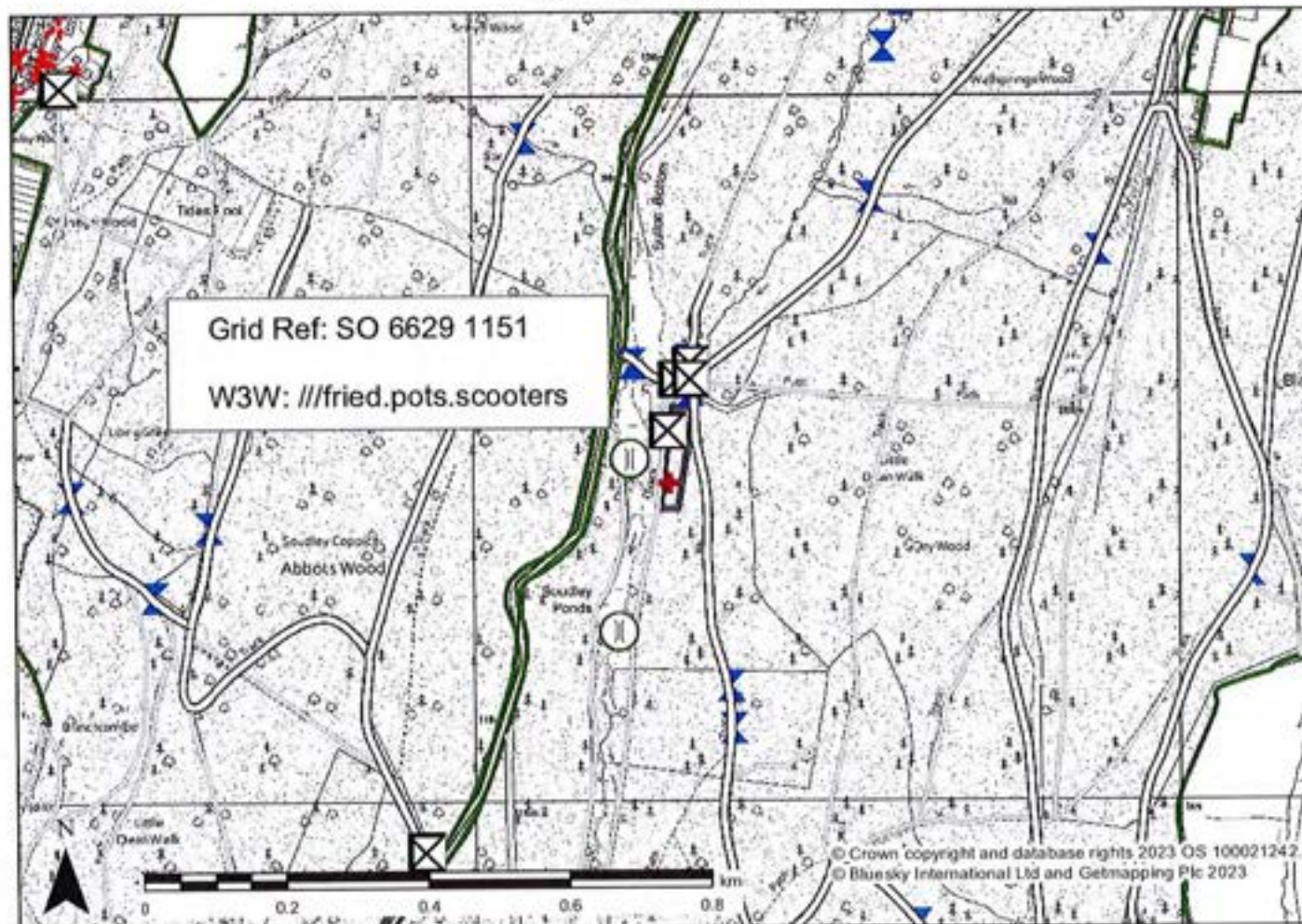

## Legend

<b>Gates/Cattle Grids/Barriers</b>	<b>Forest Roads</b>	<b>Culverts</b>	<b>Minor Roads (GB)</b>
Gates/Cattle Grids/Barriers	Forest Roads	Culverts	Minor Roads (GB)
<b>Timber Stacking Sites</b>	<b>Rides</b>	<b>Hardwood Auction Site Plan (Eng.)</b>	
Timber Stacking Sites	Rides	Hardwood Auction Site Plan (Eng.)	
<b>Bridges</b>	<b>Electricity Powerlines</b>	<b>Blocks</b>	
Bridges	Overhead powerline	Blocks	
	Underground powerline		

## Notes

Contract No: F55344

Grid Ref: SO 6628 1148

Site Name: FoD Blaize Bailey Larch Log Poles 1

### Access Information:

From Upper Soudley, head north on Sutton Road for 0.8 miles, turning right into Soudley Ponds car park. Access through the steel barrier at the back (FE key required). From the A4151 at Littledean, head south on Sutton Road for 1.3 miles, turning left into Soudley Ponds car park.



**LOT 26**

**WOOD**

Blaize Bailey, Forest of Dean

**DESCRIPTION**

Conifer logs at roadside by volume

**AGENT RESPONSIBLE**

Simon McGrath  
Forestry England, Coleford Office  
West England Forest District  
Email:  
simon.mcgrath@forestryengland.uk  
Tel: 07795 612842



**REF:** F55345

Species	Number of logs	Estimated Quantity	Unit	Measurement procedure
European Larch	46	46.45	M³obf	Length and mid-diameter over bark
<b>Totals</b>	<b>46</b>	<b>46.45</b>		

**VIEWING ARRANGEMENTS**

By appointment during normal working hours. A log list will be available from the agent on 16/10/23.

**SPECIAL CONDITIONS**

1. Contract period from 14/12/23 to 31/01/24
2. Contract Schedules and maps available from above address.
3. No chainsaw use without prior written permission from the contract manager.
4. All products detailed in the log list must be removed.

**PAYMENT**

One instalment due on 14/12/23.

Payment is required before uplift unless the Purchaser has sufficient credit with Forestry England. Forestry England may also charge a 10% deposit depending on the Purchaser's status. See the clauses in sections 13.13 to 13.15 of Forestry England's Standard Conditions for Forest Products.

**METHOD OF MARKING**

Timber tags

**BIDDING**

Bids will be taken on a price per cubic metre over bark basis.

# Site Plan

Lot 26

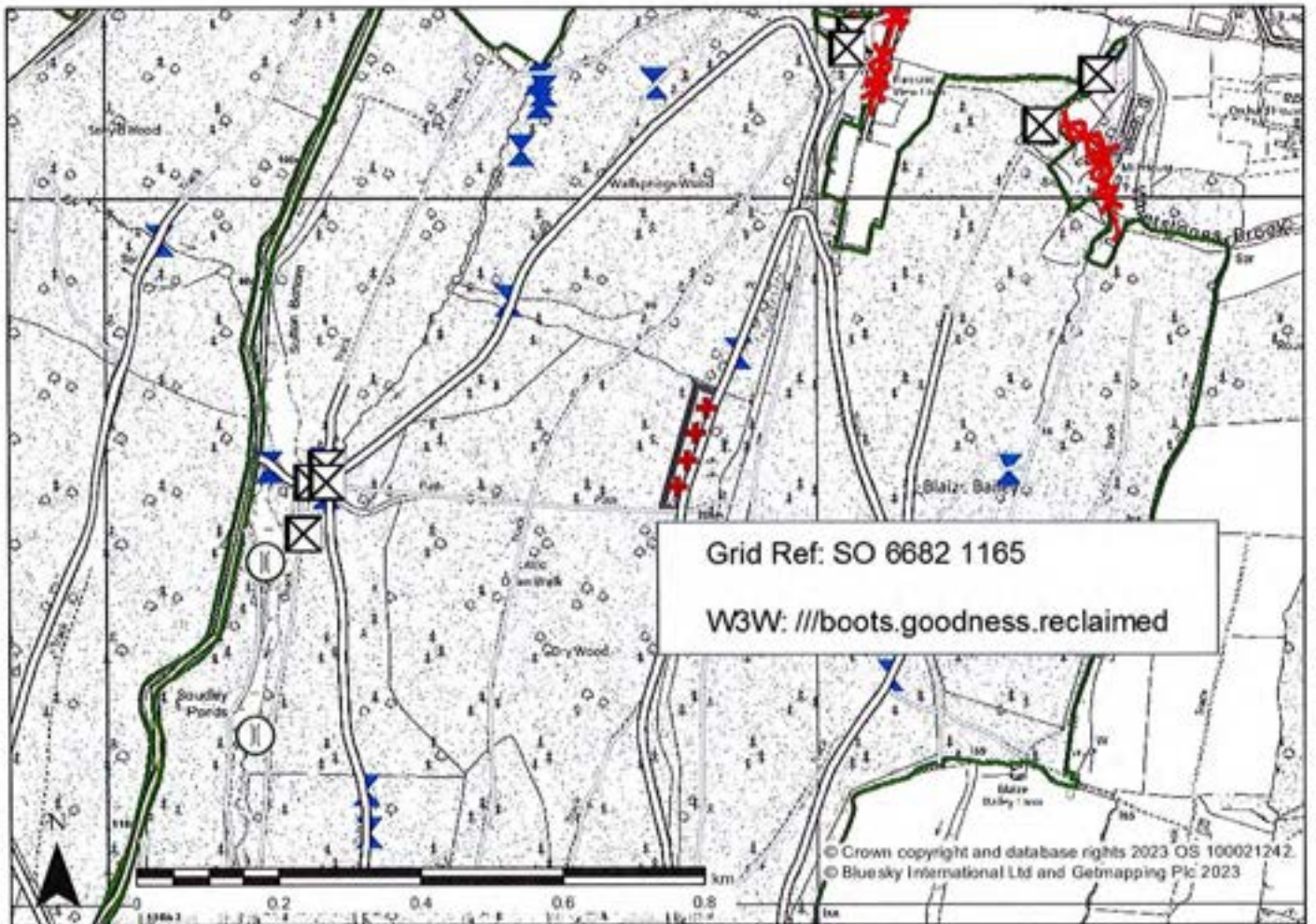

## Legend

Gates/Cattle Grids/Barriers	Forest Roads	Culverts	Minor Roads (GB)
Gates/Cattle Grids/Barriers	Forest Roads	Culverts	Minor Roads (GB)
Timber Stacking Sites	Rides	Hardwood Auction Site Plan (Eng.)	
Timber Stacking Sites	Rides	Hardwood Auction Site Plan (Eng.)	
Bridges	Electricity Powerlines	Blocks	
Bridges	Overhead powerline	Blocks	
	Underground powerline		

## Notes

Contract No: F55345

Grid Ref: SO 6681 1164

Site Name: FoD Blaize Bailey Larch Log Poles 2

### Access Information:

From Upper Soudley, head north on Sutton Road for 0.8 miles, turning right into Soudley Ponds car park. Access through the steel barrier at the back (FE key required). From the A4151 at Littledean, head south on Sutton Road for 1.3 miles, turning left into Soudley Ponds car park.



**LOT 27****WOOD**

Blaize Bailey, Forest of Dean

**DESCRIPTION**

Conifer logs at roadside by volume

**AGENT RESPONSIBLE**

Simon McGrath  
Forestry England, Coleford Office  
West England Forest District  
Email:  
simon.mcgrath@forestryengland.uk  
Tel: 07795 612842



**REF:** F55346

Species	Number of logs	Estimated Quantity	Unit	Measurement procedure
European Larch	45	57.01	M <sup>3</sup> obf	Length and mid-diameter over bark
<b>Totals</b>	<b>45</b>	<b>57.01</b>		

**VIEWING ARRANGEMENTS**

By appointment during normal working hours. A log list will be available from the agent on 16/10/23.

**SPECIAL CONDITIONS**

1. Contract period from 14/12/23 to 31/01/24
2. Contract Schedules and maps available from above address.
3. No chainsaw use without prior written permission from the contract manager.
4. All products detailed in the log list must be removed.

**PAYMENT**

One instalment due on 14/12/23.

Payment is required before uplift unless the Purchaser has sufficient credit with Forestry England. Forestry England may also charge a 10% deposit depending on the Purchaser's status. See the clauses in sections 13.13 to 13.15 of Forestry England's Standard Conditions for Forest Products.

**METHOD OF MARKING**

Timber tags

**BIDDING**

Bids will be taken on a price per cubic metre over bark basis.



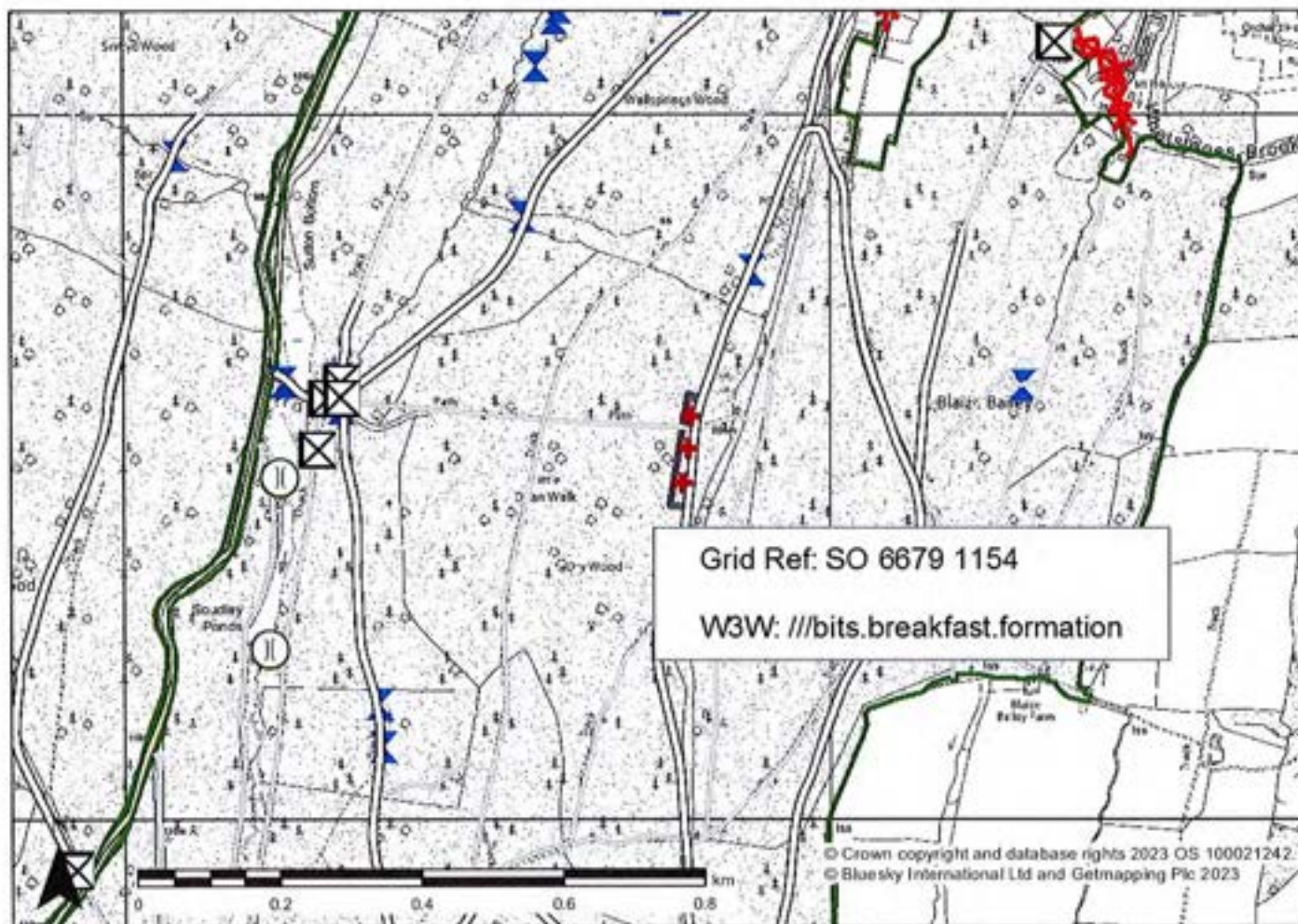

**Legend**

Gates/Cattle Grids/Barriers	Forest Roads	Culverts	Minor Roads (GB)
Timber Stacking Sites	Rides	Hardwood Auction Site Plan (Eng.)	Minor Roads (GB)
Bridges	Electricity Powerlines	Blocks	
	Overhead powerline		
	Underground powerline		

## Notes

Contract No: F55346

Grid Ref: SO 6679 1152

Site Name: FoD Blaze Bailey Larch Log Poles 3

**Access Information:**  
 From Upper Soudley, head north on Sutton Road for 0.8 miles, turning right into Soudley Ponds car park. Access through the steel barrier at the back (FE key required).  
 From the A4151 at Littledean, head south on Sutton Road for 1.3 miles, turning left into Soudley Ponds car park.



**LOT 28**

**WOOD**

Blaize Bailey, Forest of Dean

**DESCRIPTION**

Conifer logs at roadside by volume

**AGENT RESPONSIBLE**

Simon McGrath  
Forestry England, Coleford Office  
West England Forest District  
Email:  
simon.mcgrath@forestryengland.uk  
Tel: 07795 612842

**REF:** F55347



Species	Number of logs	Estimated Quantity	Unit	Measurement procedure
European Larch	45	65.66	M <sup>3</sup> obf	Length and mid-diameter over bark
<b>Totals</b>	<b>45</b>	<b>65.66</b>		

**VIEWING ARRANGEMENTS**

By appointment during normal working hours. A log list will be available from the agent on 16/10/23.

**SPECIAL CONDITIONS**

1. Contract period from 14/12/23 to 31/01/24
2. Contract Schedules and maps available from above address.
3. No chainsaw use without prior written permission from the contract manager.
4. All products detailed in the log list must be removed.

**PAYMENT**

One instalment due on 14/12/23.

Payment is required before uplift unless the Purchaser has sufficient credit with Forestry England. Forestry England may also charge a 10% deposit depending on the Purchaser's status. See the clauses in sections 13.13 to 13.15 of Forestry England's Standard Conditions for Forest Products.

**METHOD OF MARKING**

Timber tags

**BIDDING**

Bids will be taken on a price per cubic metre over bark basis.

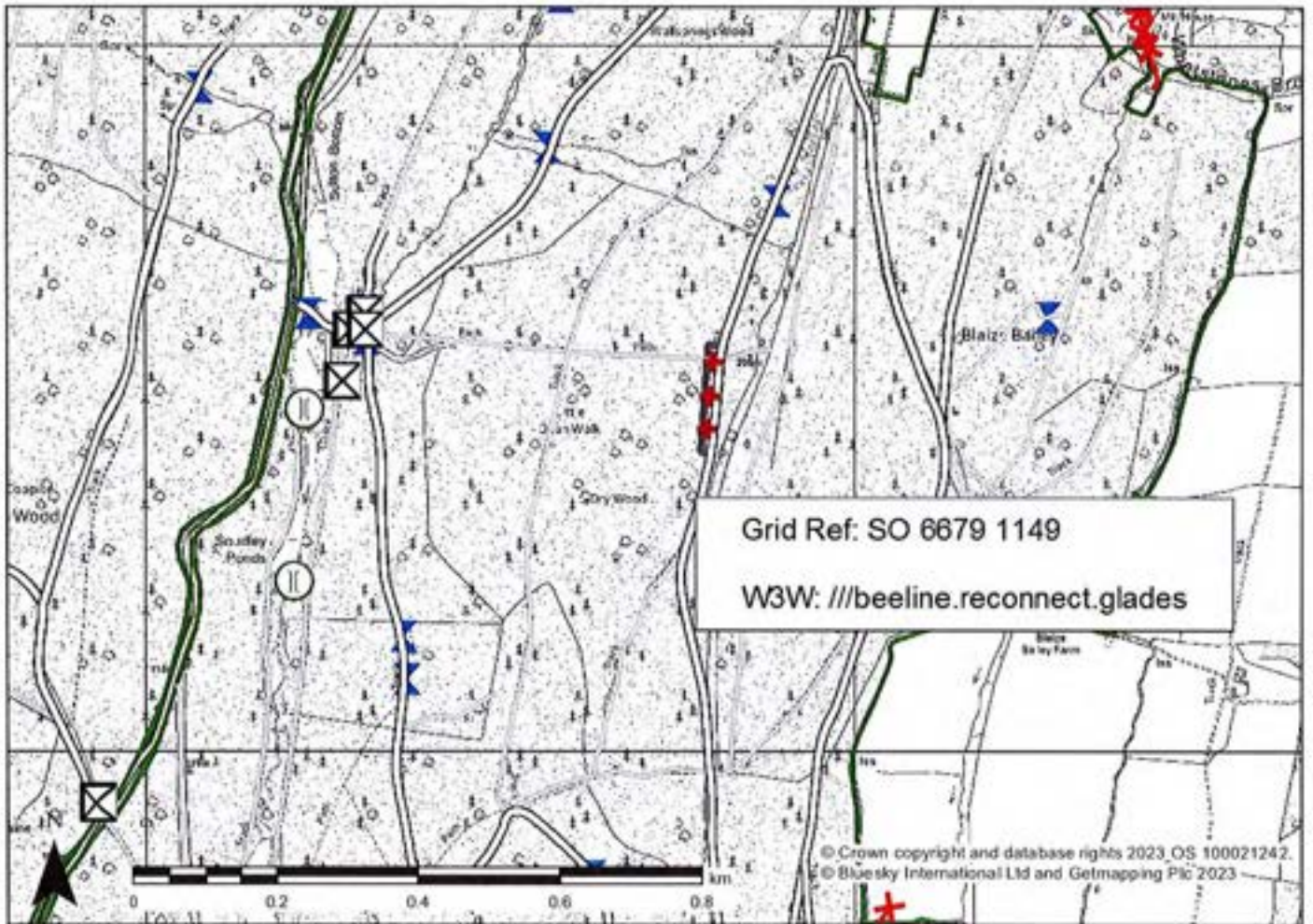

© Crown copyright and database rights 2023 OS 100021242.  
© Bluesky International Ltd and Getmapping Plc 2023

**Legend**

Gates/Cattle Grids/Barriers	Forest Roads	Culverts	Minor Roads (GB)
Timber Stacking Sites	Rides	Hardwood Auction Site Plan (Eng.)	
Bridges	Electricity Powerlines	Blocks	
	Overhead powerline		
	Underground powerline		

## Notes

Contract No: F55347

Grid Ref: SO 6679 1149

Site Name: FoD Blaise Bailey Larch Log Poles 4

**Access Information:**

From Upper Soudley, head north on Sutton Road for 0.8 miles, turning right into Soudley Ponds car park. Access through the steel barrier at the back (FE key required). From the A4151 at Littledean, head south on Sutton Road for 1.3 miles, turning left into Soudley Ponds car park.

