

# Salcey Forest // Enchanted Forest ~ Toddler Area Sand Option

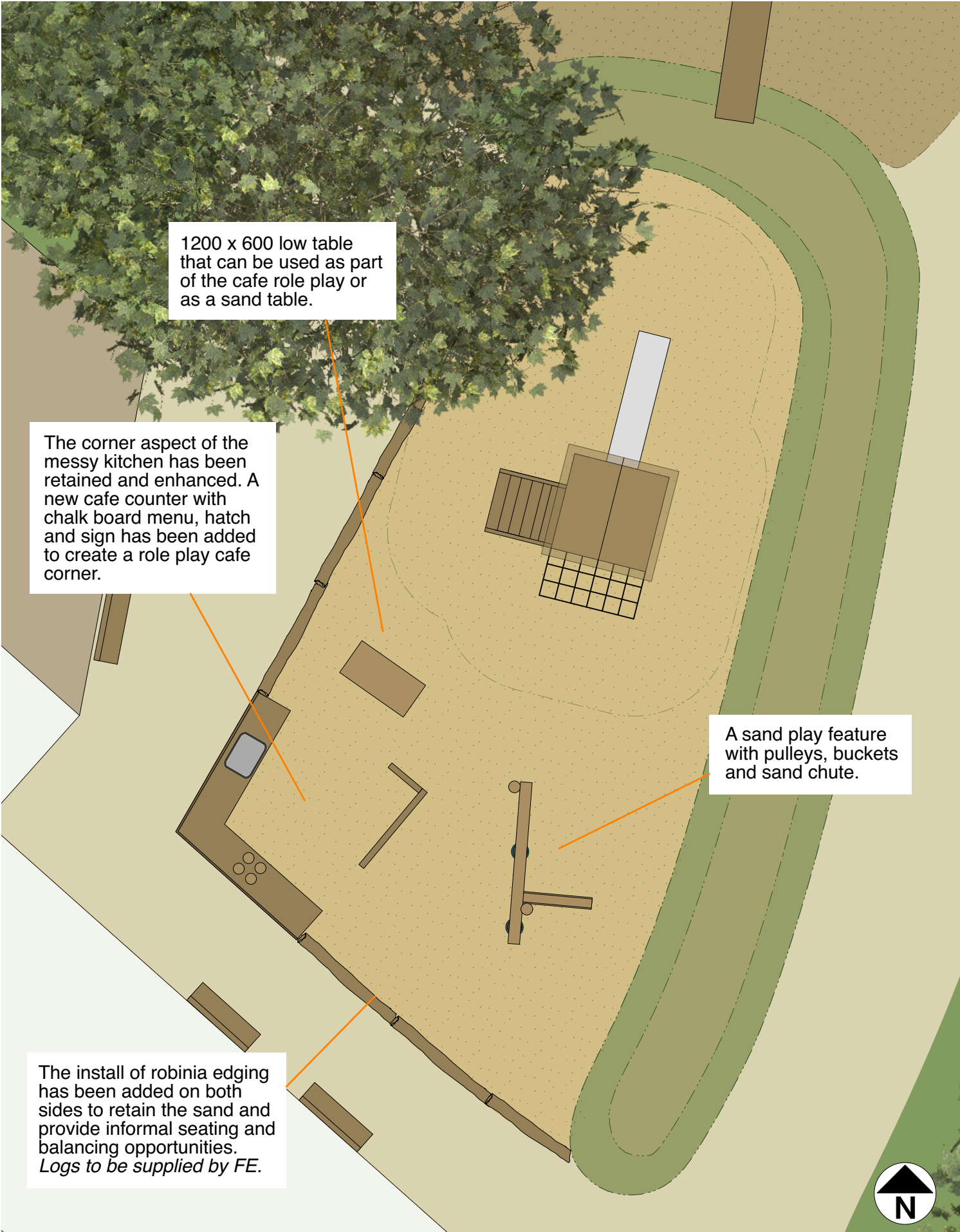

Scale 1:75 @ A3

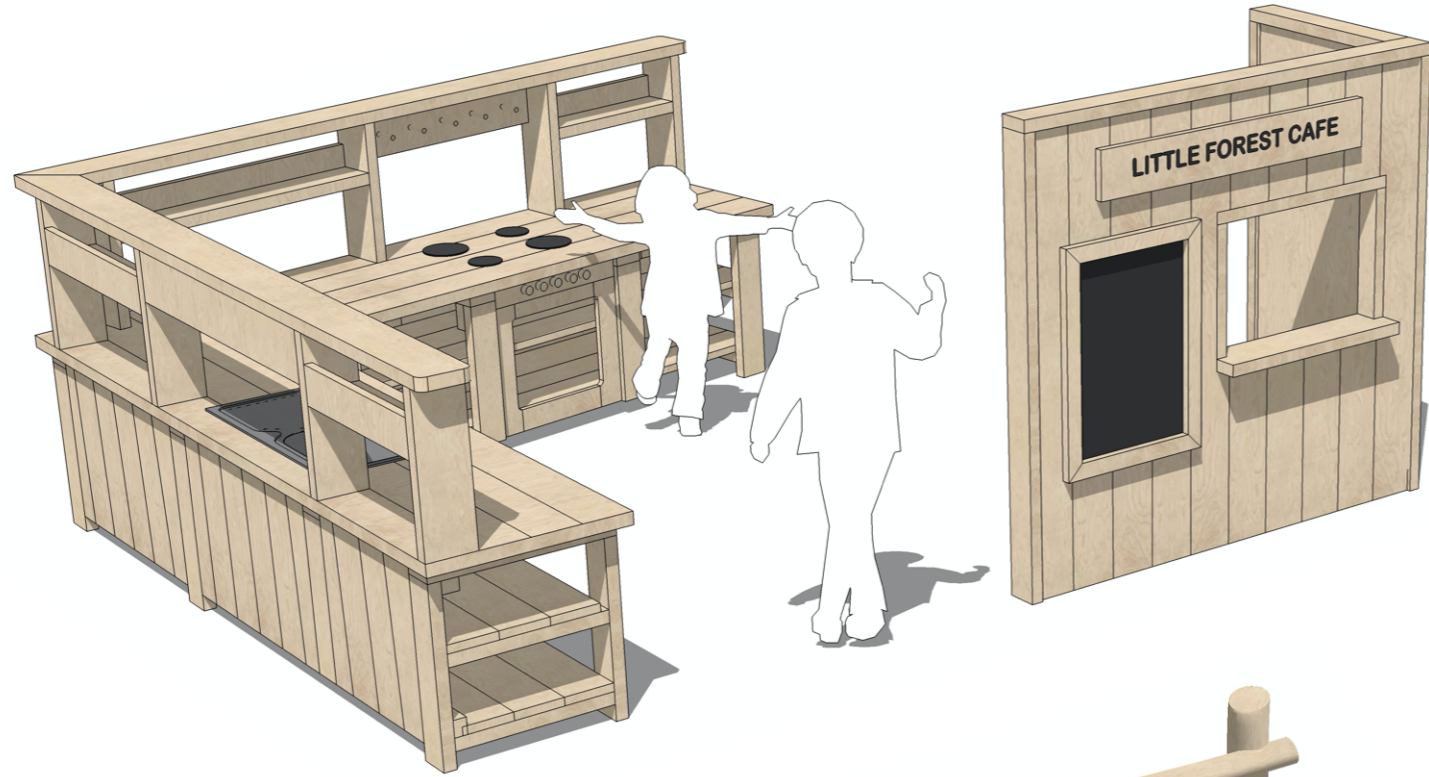

NB. All our play equipment adheres to safety standard BS EN1176/77 and we provide the client with a ROSPA Post Installation Inspection. All images are purely inspirational to demonstrate similar play outcomes, quality of workmanship and material choices.

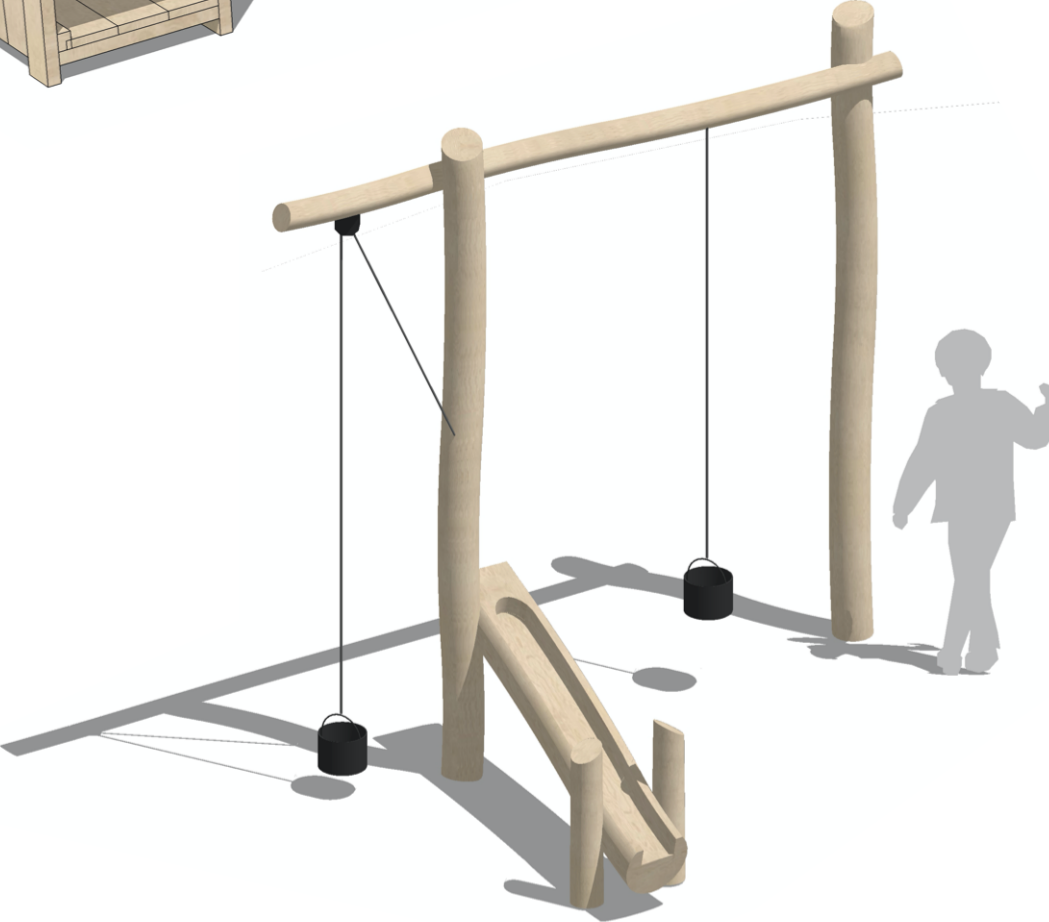

CLIENT Forestry England - Salcey Forest		ISSUE DATE 11/11/2022
DRAWING NUMBER 220904SF	SHEET NUMBER 01	REVISION 01
DRAWN BY JN	